

BUILDING CHARACTERISTICS	
ELEMENT	CD CONSTRUCTION
Exterior Wall	05 AVERAGE 100
Roof Structur	03 GABLE/HIP 100
Roof Cover	03 COMP SHNGL 100
Interior Wall	05 DRYWALL 100
Interior Floor	14 CARPET 90
Interior Floor	08 SHT VINYL 10
Air Condition	03 CENTRAL 100
Heating Type	04 AIR DUCTED 100
Bedrooms	3 100
Bathrooms	2 100
Frame	02 WOOD FRAME 100
Stories	1. 1. 100
Units	0 100
BUD8 Adjustme	04 DIST 01 100

MARKET ADJUSTMENTS														
TYPE	MDL	EFF. AREA	TOT ADJ PTS	EFF. BASE RATE	REPL. COST NEW	AYB	EYB	ECON	FNCT	NORM	% COND			
0820	02	2,052	117.6000	94.08	193,052	1992	2009	0	0	0	38.00	62.00		
1 M/H 93- - 0% - 0 Heated Area: 2052 HX Base Yr														

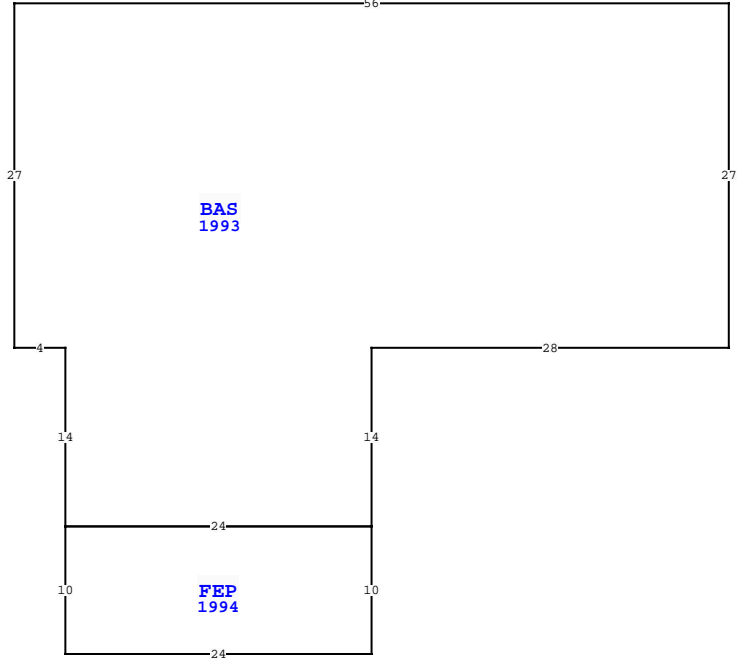

Quality	03	Quality Level 03			
DOR CODE	0200	MOBILE HOME			
MAP NUM		MKT AREA 04			
NEIGHBORHOOD/LOC	4040.00				
AREA TYPE	TOTAL GROSS AREA	PCT OF BASE	YEAR	TOT ADJ AREA	SUBAREA MARKET VALUE
BAS	1,848	100	1993	1,848	107,793
FEP	240	85	1994	204	11,899
TOTALS	2,088			2,052	119,692

NASSAU COUNTY PROPERTY		PAGE 1 of 1	4
VALUATION SUMMARY			
VALUATION BY			STANDARD
Tax Group: 4	Tax Dist:		
BUILDING MARKET VALUE			119,692
TOTAL MARKET OB/XF VALUE			128
TOTAL LAND VALUE - MARKET			85,000
TOTAL MARKET VALUE			204,820
SOH/AGL Deduction			22,240
ASSESSED VALUE			182,580
TOTAL EXEMPTION VALUE			0
BASE TAXABLE VALUE			182,580
TOTAL JUST VALUE			204,820
NCON VALUE			0
INCOME VALUE			
PREVIOUS YEAR MKT VALUE			188,237

PERMIT NUM	DESCRIPTION	AMT	ISSUED
373	ADDITION	2,400	07/01/1993
9115	MH MOVE-ON	18,500	11/18/1992

SALES DATA						
OFF RECORD Number	DATE	TYPE INST	Q U	V I	RSN CD	SALE PRICE
2321/1178	11/15/2019	QC	U	I	11	100
GRANTOR: HASPEL STACY						
GRANTEE: HASPEL GREGORY A						
2197/0166	5/16/2018	WD	Q	I	02	117,000
GRANTOR: DUNMAN DEBORAH A & JO						
GRANTEE: HASPEL GREGORY A II						

EXTRA FEATURES															
L N	OB/XF CODE	DESCRIPTION	BLD CAP	L W	UNITS	UT	Adj R	ADJ UNIT PRICE	ORIG COND	YEAR ON	YEAR ACTUAL	Q	% COND	OB/XF MKT VALUE	NOTES
1	1242	WD DECK A	0	0	8	8		64.00	SF	10.00				128	

BUILDING NOTES			
86195 JEAN RD, YULEE			

BUILDING DIMENSIONS			
BAS=[YR=1993] W56 S27 E4 S14 FEP=[YR=1994] S10 E24 N10 W24\$ E24 N14 E28 N27\$.			

LAND DESCRIPTION										TOTAL OB/XF														
L N	USE CODE	CLS	LAND USE DESCRIPTION	CAP	R D	LOC ZONE	FRONT	DEPTH	TOT LND UTS	UNIT TYPE	D T	DPH FACT	% COND	TOT ADJ	UNIT PRICE	ADJ UNIT PRICE	LAND VALUE	OTHER ADJUSTMENTS AND NOTES	YEAR	DENSITY	DECL	FRZ	YR	CONSRV
1	000100	C	RES	0		RM	153.00	286.00	1.00	AC		1.00	1.00	1.00	85,000.00	85,000.00	85,000							