

| BUILDING CHARACTERISTICS | | CONSTRUCTION | |
|--------------------------|------------------|---------------|------|
| ELEMENT | CD | | |
| Exterior Wall | 20 | FACE BRICK | 100 |
| Roof Structur | 03 | GABLE/HIP | 100 |
| Roof Cover | 03 | COMP SHNGL | 100 |
| Interior Wall | 05 | DRYWALL | 100 |
| Interior Floo | 08 | SHT VINYL | 100 |
| Air Condition | 03 | CENTRAL | 100 |
| Heating Type | 04 | AIR DUCTED | 100 |
| Bedrooms | | 3 | 100 |
| Bathrooms | | 2 | 100 |
| Frame | 02 | WOOD FRAME | 100 |
| Stories | 1. | 1. | 100 |
| Units | | 0 | 100 |
| Occupancy | 00 | NONE | 100 |
| Quality | 04 | Quality Level | 04 |
| DOR CODE | 0100 | SINGLE FAMILY | |
| MAP NUM | | MKT AREA | 08 |
| NEIGHBORHOOD/LOC | 8015.00 | | |
| AREA TYPE | TOTAL GROSS AREA | PCT OF BASE | YEAR |
| BAS | 1,918 | 100 | 2016 |
| FGR | 438 | 55 | 2016 |
| FOP | 31 | 30 | 2016 |
| USP | 220 | 30 | 2016 |
| TOTALS | 2,607 | | |

| MARKET ADJUSTMENTS | | | | | | | | | | | |
|--|-----|-----------|-------------|----------------|----------------|------|------|------|------|------|--------|
| TYPE | MDL | EFF. AREA | TOT ADJ PTS | EFF. BASE RATE | REPL. COST NEW | AYB | EYB | ECON | FNCT | NORM | % COND |
| 0900 | 01 | 2,234 | 111.1320 | 146.69 | 327,705 | 2016 | 2016 | 0 | 0 | 6.00 | 94.00 |
| 1 SNGL FAM - 100% - 2017 Heated Area: 1918 HX Base Yr 2017 | | | | | | | | | | | |

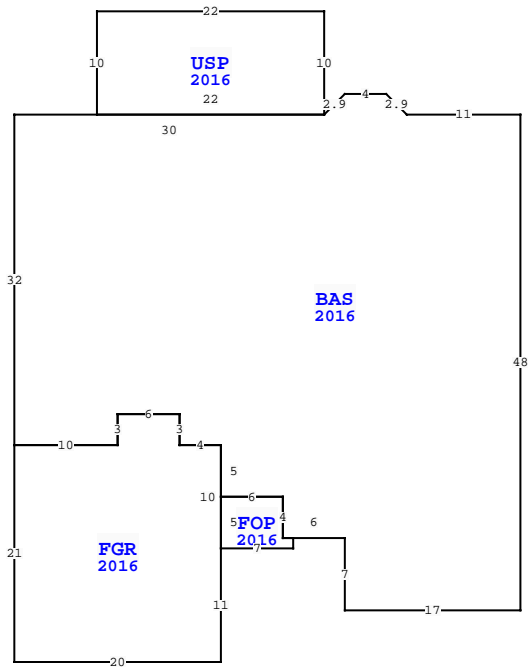

| NASSAU COUNTY PROPERTY | | PAGE 1 of 1 | 6 |
|---------------------------|-----------|-------------|----------|
| VALUATION SUMMARY | | | |
| VALUATION BY | | | STANDARD |
| Tax Group: 6 | Tax Dist: | | |
| BUILDING MARKET VALUE | | | 308,043 |
| TOTAL MARKET OB/XF VALUE | | | 10,225 |
| TOTAL LAND VALUE - MARKET | | | 60,000 |
| TOTAL MARKET VALUE | | | 378,268 |
| SOH/AGL Deduction | | | 163,762 |
| ASSESSED VALUE | | | 214,506 |
| TOTAL EXEMPTION VALUE | HX HB DX | | 55,722 |
| BASE TAXABLE VALUE | | | 158,784 |
| TOTAL JUST VALUE | | | 378,268 |
| NCON VALUE | | | 0 |
| INCOME VALUE | | | |
| PREVIOUS YEAR MKT VALUE | | | 364,387 |

| PERMIT NUM | DESCRIPTION | AMT | ISSUED |
|------------|-------------|---------|------------|
| B1631898 | CO ISSUED | 0 | 05/12/2016 |
| B1631898 | NEW CONSTR | 222,183 | 03/01/2016 |

| SALES DATA | | | | | | |
|--------------------------------|-----------|-----------|-------|-------|--------|------------|
| OFF RECORD Number | DATE | TYPE INST | Q / U | V / I | RSN CD | SALE PRICE |
| 2047/1018 | 5/20/2016 | WD Q | Q | I | 01 | 219,000 |
| GRANTOR: KENNETH L GREENE CONT | | | | | | |
| GRANTEE: OLIVER CHARLES BRUC | | | | | | |
| 2047/1015 | 5/20/2016 | QC U | U | I | 11 | 100 |
| GRANTOR: GREENE KENNETH I | | | | | | |
| GRANTEE: KENNETH L GREENE CO | | | | | | |

| EXTRA FEATURES | | | | | | | | | | | |
|----------------|------------|-------------|---------|-----|---|----------|----|-------|----------------|-----------|---------|
| L N | OB/XF CODE | DESCRIPTION | BLD CAP | L | W | UNITS | UT | Adj R | ADJ UNIT PRICE | ORIG COND | YEAR ON |
| 1 | 0811 | CONCRETE B | 0 | 100 | 0 | 1,843.00 | SF | 5.20 | 5.20 | 100 | 2016 |
| 2 | 0810 | CONCRETE A | 0 | 100 | 0 | 176.00 | SF | 6.50 | 6.50 | 100 | 2020 |

| TOTAL OB/XF | | | | | | | | | | | |
|-------------|----------|-----|----------------------|-----|-----|----------|-------|-------|-------------|-----------|------|
| 10,225 | | | | | | | | | | | |
| L N | USE CODE | CLS | LAND USE DESCRIPTION | CAP | R D | LOC ZONE | FRONT | DEPTH | TOT LND UTS | UNIT TYPE | D T |
| 1 | 000134 | C | RES POND | 100 | | OR | 0.00 | 0.00 | 1.00 | LT | 1.00 |

| BUILDING NOTES | | | | | | | | | | | |
|--|--|--|--|--|--|--|--|--|--|--|--|
| BAS=[YR=2016] W11 U2 L2 W4 D2 L2 USP=[YR=2016] N10 W22 S10 E22\$ W30 S32 FGR=[YR=2016] S21 E20 N11 FOP=[YR=2016] E7 N1 W1 N4 W6 S5\$ N10 W4 N3 W6 S3 W10\$ E10 N3 E6 S3 E4 S5 E6 S4 E6 S7 E17 N48\$. | | | | | | | | | | | |

| BUILDING DIMENSIONS | | | | | | | | | | | |
|--|--|--|--|--|--|--|--|--|--|--|--|
| BAS=[YR=2016] W11 U2 L2 W4 D2 L2 USP=[YR=2016] N10 W22 S10 E22\$ W30 S32 FGR=[YR=2016] S21 E20 N11 FOP=[YR=2016] E7 N1 W1 N4 W6 S5\$ N10 W4 N3 W6 S3 W10\$ E10 N3 E6 S3 E4 S5 E6 S4 E6 S7 E17 N48\$. | | | | | | | | | | | |

| LAND DESCRIPTION | | | | | | | | | | | |
|------------------|----------|-----|----------------------|-----|-----|----------|-------|-------|-------------|-----------|------|
| L N | USE CODE | CLS | LAND USE DESCRIPTION | CAP | R D | LOC ZONE | FRONT | DEPTH | TOT LND UTS | UNIT TYPE | D T |
| 1 | 000134 | C | RES POND | 100 | | OR | 0.00 | 0.00 | 1.00 | LT | 1.00 |