

BUILDING CHARACTERISTICS		
ELEMENT	CD	CONSTRUCTION
Exterior Wall	31	HARDIE BRD 70
Exterior Wall	16	WD FR STUC 30
Roof Structure	03	GABLE/HIP 100
Roof Cover	03	COMP SHNGL 100
Interior Wall	05	DRYWALL 100
Interior Floor	14	CARPET 70
Interior Floor	11	CLAY TILE 30
Air Condition	03	CENTRAL 100
Heating Type	04	AIR DUCTED 100
Bedrooms		4 100
Bathrooms		2 100
Frame	02	WOOD FRAME 100
Stories	1.	1. 100
Units		0 100
Occupancy	00	NONE 100

MARKET ADJUSTMENTS											
TYPE	MDL	EFF. AREA	TOT ADJ PTS	EFF. BASE RATE	REPL. COST NEW	AYB	EYB	ECON	FNCT	NORM	% COND
0100	01	2,425	119.5502	119.55	289,909	2013	2013	0	0	5.15	94.85

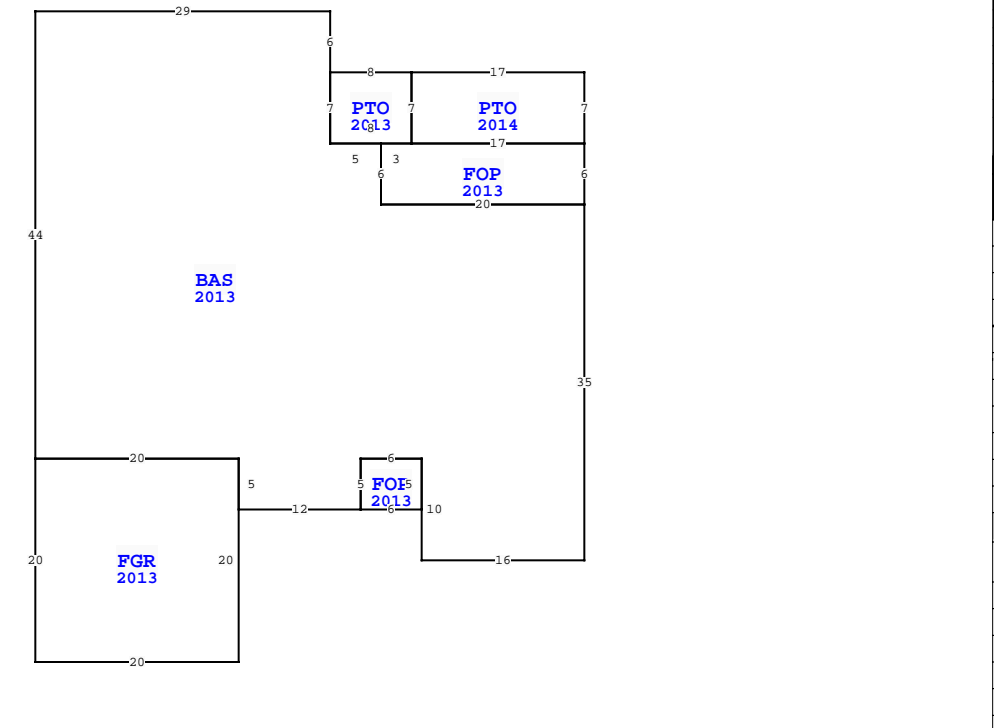

Quality	05	Quality Level 05
DOR CODE	0100	SINGLE FAMILY
MAP NUM		MKT AREA 04
NEIGHBORHOOD/LOC	4063.00	
AREA TYPE	TOTAL GROSS AREA	PCT OF BASE
BAS	2,151	100
FGR	400	55
FOP	30	30
FOP	120	30
PTO	56	5
PTO	119	5
TOTALS	2,876	

NASSAU COUNTY PROPERTY		
VALUATION SUMMARY		PAGE 1 of 1
VALUATION BY	Tax Group: 4	STANDARD
BUILDING MARKET VALUE		274,979
TOTAL MARKET OB/XF VALUE		6,337
TOTAL LAND VALUE - MARKET		125,000
TOTAL MARKET VALUE		406,316
SOH/AGL Deduction		0
ASSESSED VALUE		406,316
TOTAL EXEMPTION VALUE		0
BASE TAXABLE VALUE		406,316
TOTAL JUST VALUE		406,316
NCON VALUE		0
INCOME VALUE		0
PREVIOUS YEAR MKT VALUE		364,242

PERMIT NUM	DESCRIPTION	AMT	ISSUED
B1429170	ADDITION	2,676	08/01/2014
B1327295	CO ISSUED	0	12/27/2013
E1326597	NEW CONSTR	0	08/01/2013
B1327295	NEW CONSTR	249,337	06/01/2013

SALES DATA						
OFF RECORD Number	DATE	TYPE INST	Q / U	V / I	RSN CD	SALE PRICE
2343/1929	2/27/2020	WD Q	Q	I	02	275,000
GRANTOR: GRIFFITT MICHAEL R &						
GRANTEE: SCHLECKER LOUIS & K						
2117/1444	5/01/2017	WD Q	Q	I	01	248,000
GRANTOR: HATCH JOSHUA K & JENN						
GRANTEE: GRIFFITT MICHAEL R						

EXTRA FEATURES											
L N	OB/XF CODE	DESCRIPTION	BLD CAP	L	W	UNITS	UT	Adj R	ADJ UNIT PRICE	ORIG COND	YEAR ON
1	0811	CONCRETE B	0	0	0	795.00	SF	5.20	5.20	100	2013
2	0911	SCRN RM A	0	0	7	119.00	SF	17.50	17.50	100	2014
3	0463	FENCE GATE	0	0	30	1.00	UT	300.00	300.00	100	2017
4	0462	ST/AL FNC	0	0	0	120.00	SF	10.00	10.00	100	2017

BLD DATE	03/03/2023	NW	LGL DATE	
XF DATE			LAND DATE	04/03/2025
INC DATE			AG DATE	MLU
97122 BLUFF VIEW CIR, YULEE				
TOTAL OB/XF 6,337				

BUILDING NOTES											
BUILDING DIMENSIONS											

PTO=[YR=2014] N7 W17 S7 E17\$FOP=[YR=2013] W17 PTO=[YR=2013]
N7 W8 BAS=[YR=2013] N6 W29 S44 FGR=[YR=2013] S20 E20 N20 W20
\$ E20 S5 E12 FOP=[YR=2013] E6 N5 W6 S5 \$ N5 E6 S10 E16 N35
W20 N6 W5 N7 \$ S7 E8 \$ W3 S6 E20 N6 \$.

LAND DESCRIPTION											
L N	USE CODE	CLS	LAND USE DESCRIPTION	CAP	R D	LOC ZONE	FRONT	DEPTH	TOT LND UTS	UNIT TYPE	DPTH FACT
1	000100	C	RES	0		RSF-1	0.00	0.00	1.00	LT	1.00