

BUILDING CHARACTERISTICS		CONSTRUCTION	
ELEMENT	CD		
Exterior Wall	16	WD FR STUC	100
Roof Structur	03	GABLE/HIP	100
Roof Cover	03	COMP SHNGL	100
Interior Wall	05	DRYWALL	100
Interior Floo	14	CARPET	80
Interior Floo	11	CLAY TILE	20
Air Condition	03	CENTRAL	100
Heating Type	04	AIR DUCTED	100
Bedrooms		3	100
Bathrooms		2	100
Frame	02	WOOD FRAME	100
Stories	1.	1.	100
Units		0	100
Occupancy	00	NONE	100
Quality	03	Quality Level	03
DOR CODE	0100	SINGLE FAMILY	
MAP NUM		MKT AREA	05
NEIGHBORHOOD/LOC	5005.00		
AREA TYPE	TOTAL GROSS AREA	PCT OF BASE	YEAR
BAS	1,767	100	2008
FGR	426	55	2008
FOP	36	30	2008
FOP	132	30	2008
PTO	375	5	2026
TOTALS	2,736		

MARKET ADJUSTMENTS													
TYPE	MDL	EFF. AREA	TOT ADJ PTS	EFF. BASE RATE	REPL. COST NEW	AYB	EYB	ECON	FNCT	NORM	% COND		
1	SINGLE FAM	- 0%	- 0	109.3680	109.37	226,505	2008	2008	0	0	0	8.00	92.00
Heated Area: 1767 HX Base Yr													

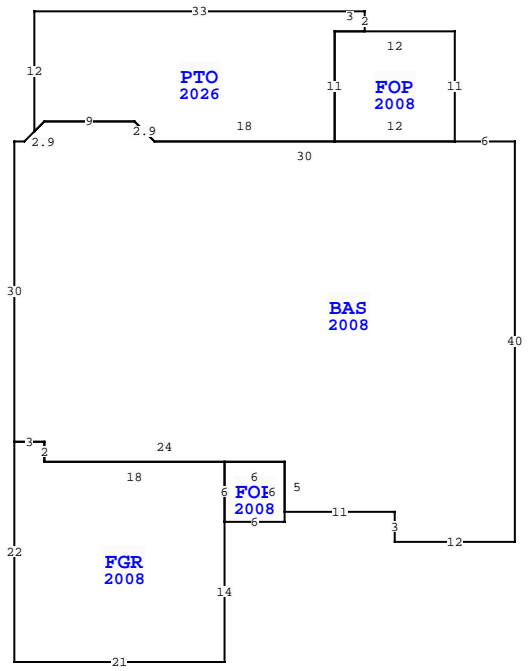

NASSAU COUNTY PROPERTY		PAGE 1 of 1	4
VALUATION SUMMARY			
VALUATION BY	STANDARD		
Tax Group: 4	Tax Dist:		
BUILDING MARKET VALUE			208,385
TOTAL MARKET OB/XF VALUE			3,113
TOTAL LAND VALUE - MARKET			55,000
TOTAL MARKET VALUE			266,498
SOH/AGL Deduction			1,459
ASSESSED VALUE			265,039
TOTAL EXEMPTION VALUE			0
BASE TAXABLE VALUE			265,039
TOTAL JUST VALUE			266,498
NCON VALUE			0
INCOME VALUE			
PREVIOUS YEAR MKT VALUE			255,361

PERMIT NUM	DESCRIPTION	AMT	ISSUED
C21291	CO ISSUED	0	04/01/2008
P13155	OTHER	0	04/01/2008
E20743	ELEC OTHER	1,500	04/01/2008
M13793	MECH OTHER	0	04/01/2008
R11178	REPAIR/RRF	2,000	04/01/2008
B21291	NEW CONSTR	149,424	04/01/2008

SALES DATA						
OFF RECORD Number	DATE	TYPE INST	Q / U	V / I	RSN CD	SALE PRICE
2397/0176	10/02/2020	WD Q	Q	I	01	250,000
GRANTOR: ANTHONY JODI M & RONA						
GRANTEE: DEPALM JOSEPH F & S						
2237/1822	11/08/2018	WD Q	Q	I	01	229,000
GRANTOR: WARLEY EDWARD SCOTT &						
GRANTEE: ANTHONY JODI M & RO						

EXTRA FEATURES																
L N	OB/XF CODE	DESCRIPTION	BLD CAP	L	W	UNITS	UT	Adj R	ADJ UNIT PRICE	ORIG COND	YEAR ON	YEAR ACTUAL	Q	% COND	OB/XF MKT VALUE	NOTES
1	0811	CONCRETE B	0	0	0	594.00	SF	5.20	5.20	100	2008	2008	3	88	2,718	
2	0810	CONCRETE A	0	0	23	69.00	SF	6.50	6.50	100	2008	2008	3	88	395	

TOTAL OB/XF														3,113
76372 DEERWOOD DR, YULEE														
BLD DATE 02/27/2009 KK LGL DATE														
XF DATE LAND DATE														
INC DATE AG DATE														

BUILDING NOTES													
BUILDING DIMENSIONS													
BAS=[YR=2008;ORIG=0,0] W6 W30 U2L2 W9 D2L2 W1 S30 E3 S2 E24													
S5 E11 S3 E12 N40 \$													
FGR=[YR=2008;ORIG=-50,30] S22 E21 N14 N6 W18 N2 W3 \$													
FOP=[YR=2008;ORIG=-6,0] N11 W12 S11 E12 \$													
FOP=[YR=2008;ORIG=-29,38] E6 N6 W6 S6 \$													
PTO=[YR=2026;ORIG=-15,-11] N2 W33 S12 U1R1 E9 D2R2 E18 N11 E3 \$													

LAND DESCRIPTION														TOTAL OB/XF										
L N	USE CODE	CLS	LAND USE DESCRIPTION	CAP	R D	LOC ZONE	FRONT	DEPTH	TOT LND UTS	UNIT TYPE	D T	DPH FACT	% COND	TOT ADJ	UNIT PRICE	ADJ UNIT PRICE	LAND VALUE	OTHER ADJUSTMENTS AND NOTES	YEAR	DENSITY	DECL	FRZ	YR	CONSRV
1	000134	C	RES POND	0	0003	PUD	0.00	0.00	1.00	LT		1.00	1.00	1.00	55,000.00	55,000.00	55,000							