

| BUILDING CHARACTERISTICS |                     |             |      |              |                      |
|--------------------------|---------------------|-------------|------|--------------|----------------------|
| ELEMENT                  | CD                  |             |      |              |                      |
| Exterior Wall            | 05 AVERAGE 80       |             |      |              |                      |
| Exterior Wall            | 16 WD FR STUC 20    |             |      |              |                      |
| Roof Structure           | 08 IRREGULAR 100    |             |      |              |                      |
| Roof Cover               | 03 COMP SHNGL 100   |             |      |              |                      |
| Interior Wall            | 05 DRYWALL 100      |             |      |              |                      |
| Interior Floor           | 14 CARPET 80        |             |      |              |                      |
| Interior Floor           | 08 SHT VINYL 20     |             |      |              |                      |
| Air Condition            | 03 CENTRAL 100      |             |      |              |                      |
| Heating Type             | 04 AIR DUCTED 100   |             |      |              |                      |
| Bedrooms                 | 4 100               |             |      |              |                      |
| Bathrooms                | 3 100               |             |      |              |                      |
| Frame                    | 02 WOOD FRAME 100   |             |      |              |                      |
| Stories                  | 1. 1. 100           |             |      |              |                      |
| Units                    | 0 100               |             |      |              |                      |
| Occupancy                | 00 NONE 100         |             |      |              |                      |
| Quality                  | 01 Quality Level 01 |             |      |              |                      |
| DOR CODE                 | 0100 SINGLE FAMILY  |             |      |              |                      |
| MAP NUM                  | MKT AREA 08         |             |      |              |                      |
| NEIGHBORHOOD/LOC         | 8003.00             |             |      |              |                      |
| AREA TYPE                | TOTAL GROSS AREA    | PCT OF BASE | YEAR | TOT ADJ AREA | SUBAREA MARKET VALUE |
| BAS                      | 2,069               | 100         | 2003 | 2,069        | 243,196              |
| BAS                      | 480                 | 100         | 2008 | 480          | 56,421               |
| FGR                      | 440                 | 55          | 2003 | 242          | 28,445               |
| FOP                      | 49                  | 30          | 2003 | 15           | 1,763                |
| TOTALS                   | 3,038               |             |      | 2,806        | 329,826              |

| MARKET ADJUSTMENTS   |     |           |             |                |                |      |      |      |      |      |        |
|--|-----|-----------|-------------|----------------|----------------|------|------|------|------|------|--------|
| TYPE   | MDL | EFF. AREA | TOT ADJ PTS | EFF. BASE RATE | REPL. COST NEW | AYB  | EYB  | ECON | FNCT | NORM | % COND |
| 0900   | 01  | 2,806     | 93.8304     | 123.86         | 347,551        | 2003 | 2013 | 0    | 0    | 5.10 | 94.90  |
| 1 SNGL FAM - 100% - 2023 Heated Area: 2549 HX Base Yr 2023 |     |           |             |                |                |      |      |      |      |      |        |

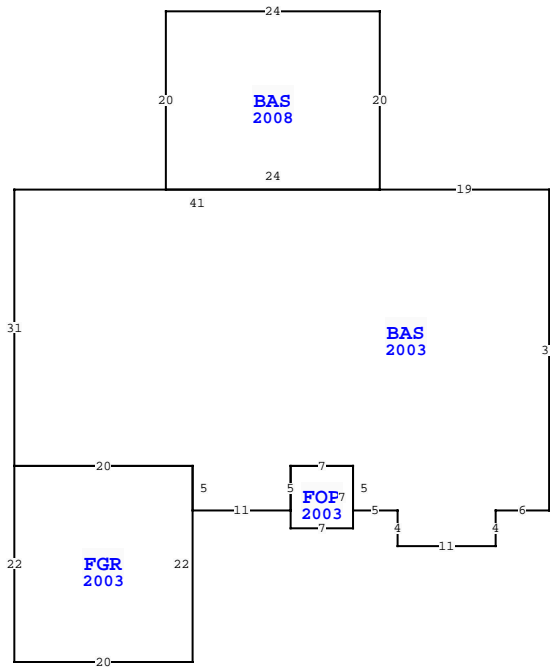

| NASSAU COUNTY PROPERTY    |  | PAGE 1 of 1  | 6 |
|---------------------------|--|--------------|---|
| VALUATION SUMMARY         |  |              |   |
| VALUATION BY              |  | STANDARD     |   |
| Tax Group: 6              |  | Tax Dist:    |   |
| BUILDING MARKET VALUE     |  | 329,826      |   |
| TOTAL MARKET OB/XF VALUE  |  | 12,193       |   |
| TOTAL LAND VALUE - MARKET |  | 70,650       |   |
| TOTAL MARKET VALUE        |  | 412,669      |   |
| SOH/AGL Deduction         |  | 30,873       |   |
| ASSESSED VALUE            |  | 381,796      |   |
| TOTAL EXEMPTION VALUE     |  | HX HB 50,722 |   |
| BASE TAXABLE VALUE        |  | 331,074      |   |
| TOTAL JUST VALUE          |  | 412,669      |   |
| NCON VALUE                |  | 0            |   |
| INCOME VALUE              |  |              |   |
| PREVIOUS YEAR MKT VALUE   |  | 381,674      |   |

| PERMIT NUM | DESCRIPTION | AMT     | ISSUED     |
|------------|-------------|---------|------------|
| 21002076   | REPAIR/RRF  | 0       | 02/22/2021 |
| 21001780   | REPAIR/RRF  | 6,500   | 02/16/2021 |
| 18008266   | REPAIR/RRF  | 15,250  | 08/13/2018 |
| B21821     | SUNROOM     | 30,888  | 08/01/2008 |
| R11498     | REPAIR/RRF  | 2,000   | 08/01/2008 |
| B0310676   | NEW CONSTR  | 154,533 | 04/09/2003 |

| SALES DATA                     |           |           |       |       |        |            |
|--------------------------------|-----------|-----------|-------|-------|--------|------------|
| OFF RECORD Number              | DATE      | TYPE INST | Q / U | V / I | RSN CD | SALE PRICE |
| 2542/0479                      | 2/22/2022 | WD        | Q     | I     | 01     | 420,000    |
| GRANTOR: STARLING RICHARD J &  |           |           |       |       |        |            |
| GRANTEE: JONES TAMEKO MICHEL   |           |           |       |       |        |            |
| 1216/1478                      | 3/19/2004 | WD        | Q     | I     |        | 189,900    |
| GRANTOR: SEDA CONSTRUCTION COM |           |           |       |       |        |            |
| GRANTEE: STARLING RICHARD J    |           |           |       |       |        |            |

| EXTRA FEATURES |            |             |         |     |    |        |    |          |                |           |         |             |   |        |                 |       |
|----------------|------------|-------------|---------|-----|----|--------|----|----------|----------------|-----------|---------|-------------|---|--------|-----------------|-------|
| L N            | OB/XF CODE | DESCRIPTION | BLD CAP | L   | W  | UNITS  | UT | Adj R    | ADJ UNIT PRICE | ORIG COND | YEAR ON | YEAR ACTUAL | Q | % COND | OB/XF MKT VALUE | NOTES |
| 1              | 0811       | CONCRETE B  | 0       | 100 | 0  | 982.00 | SF | 5.20     | 5.20           | 100       | 2003    | 2003        | 3 | 82     | 4,187           |       |
| 2              | 0500       | FP-PRE FAB  | 0       | 100 | 0  | 1.00   | UT | 3,500.00 | 3,500.00       | 100       | 2003    | 2003        | 3 | 86     | 3,010           |       |
| 3              | 0810       | CONCRETE A  | 0       | 100 | 34 | 102.00 | SF | 6.50     | 6.50           | 100       | 2003    | 2003        | 3 | 82     | 544             |       |
| 4              | 0940       | SHEDS/PORT  | 0       | 100 | 14 | 140.00 | SF | 30.00    | 30.00          | 100       | 2010    | 2010        | 3 | 40     | 1,680           |       |
| 5              | 0940       | SHEDS/PORT  | 0       | 100 | 14 | 168.00 | SF | 30.00    | 30.00          | 100       | 2013    | 2013        | 3 | 55     | 2,772           |       |
| TOTALS         |            |             |         |     |    |        |    |          |                |           |         |             |   |        | 12,193          |       |

| LAND DESCRIPTION |          | TOTAL OB/XF |                      |     |      |          |       |       |             |           |     |          |        |         |            |                | 12,193     |                             |      |         |      |     |    |        |
|------------------|----------|-------------|----------------------|-----|------|----------|-------|-------|-------------|-----------|-----|----------|--------|---------|------------|----------------|------------|-----------------------------|------|---------|------|-----|----|--------|
| L N              | USE CODE | CLS         | LAND USE DESCRIPTION | CAP | R D  | LOC ZONE | FRONT | DEPTH | TOT LND UTS | UNIT TYPE | D T | DPH FACT | % COND | TOT ADJ | UNIT PRICE | ADJ UNIT PRICE | LAND VALUE | OTHER ADJUSTMENTS AND NOTES | YEAR | DENSITY | DECL | FRZ | YR | CONSRV |
| 1                | 000100   | C           | RES                  | 100 | 0003 | PUD      | 0.00  | 0.00  | 1.57        | AC        |     | 1.00     | 1.00   | 1.00    | 45,000.00  | 45,000.00      | 70,650     |                             |      |         |      |     |    |        |