

BUILDING CHARACTERISTICS	
ELEMENT	CD CONSTRUCTION
Exterior Wall	16 WD FR STUC 80
Exterior Wall	11 BD/BN AVG 20
Roof Structure	08 IRREGULAR 100
Roof Cover	11 SLATE 100
Interior Wall	05 DRYWALL 100
Interior Floor	12 HARDWOOD 70
Interior Floor	14 CARPET 30
Air Condition	03 CENTRAL 100
Heating Type	04 AIR DUCTED 100
Bedrooms	3 100
Bathrooms	3 100
Frame	02 WOOD FRAME 100
Stories	2. 2. 100
Units	0 100
BUD8 Adjustme	05 DIST 1A 100

MARKET ADJUSTMENTS														
TYPE	MDL	EFF. AREA	TOT ADJ PTS	EFF. BASE RATE	REPL. COST NEW	AYB	EYB	ECON	FNCT	NORM	% COND			
0500	11	2,800	166.6282	263.27	737,156	1988	2010	0	0	0	7.00	93.00		

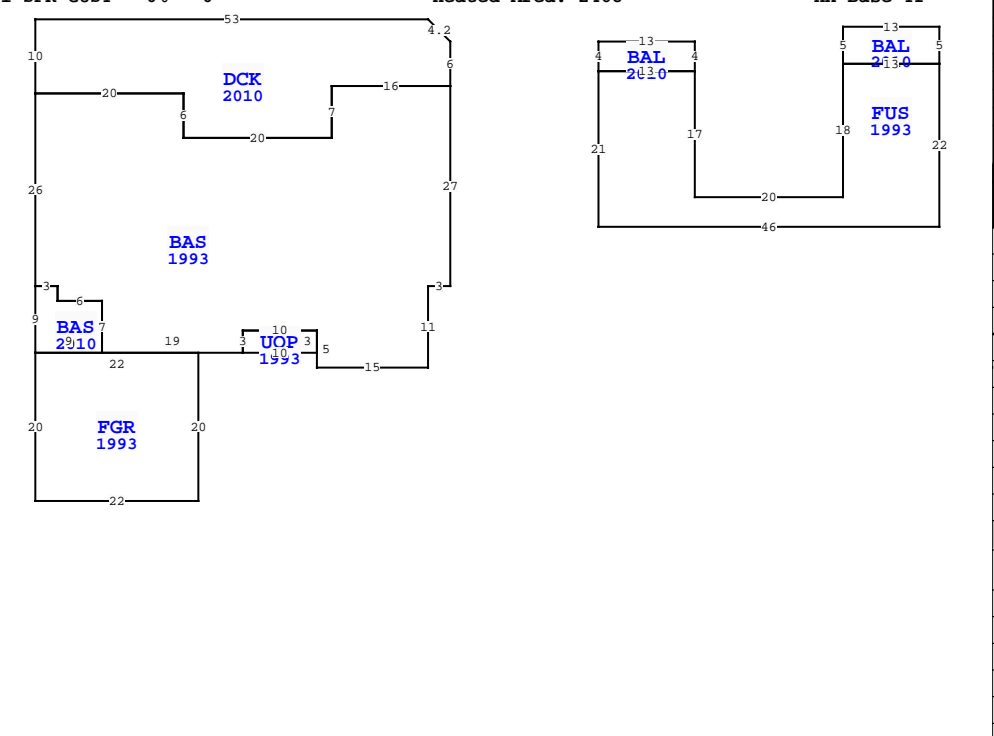

Quality	06 Quality Level 06				
DOR CODE	0100 SINGLE FAMILY				
MAP NUM	MKT AREA 10				
NEIGHBORHOOD/LOC	10001.00				
AREA TYPE	TOTAL GROSS AREA	PCT OF BASE	YEAR	TOT ADJ AREA	SUBAREA MARKET VALUE
BAL	52	15	2010	8	1,959
BAL	65	15	2010	10	2,449
BAS	1,760	100	1993	1,760	430,920
BAS	69	100	2010	69	16,894
DCK	660	10	2010	66	16,160
FGR	440	55	1993	242	59,251
FUS	639	100	1993	639	156,454
UOP	30	20	1993	6	1,469
TOTALS	3,715			2,800	685,555

NASSAU COUNTY PROPERTY		PAGE 1 of 1	5
VALUATION SUMMARY			
VALUATION BY			STANDARD
Tax Group: 5	Tax Dist:		
BUILDING MARKET VALUE			685,555
TOTAL MARKET OB/XF VALUE			16,994
TOTAL LAND VALUE - MARKET			700,000
TOTAL MARKET VALUE			1,402,549
SOH/AGL Deduction			288,380
ASSESSED VALUE			1,114,169
TOTAL EXEMPTION VALUE			0
BASE TAXABLE VALUE			1,114,169
TOTAL JUST VALUE			1,402,549
NCON VALUE			0
INCOME VALUE			
PREVIOUS YEAR MKT VALUE			1,321,571

PERMIT NUM	DESCRIPTION	AMT	ISSUED
B23029	REMODEL	175,000	11/01/2009

SALES DATA						
OFF RECORD Number	DATE	TYPE INST	Q / U	V / I	RSN CD	SALE PRICE
1958/0913	10/07/2014	WD	U	I	11	100

GRANTOR: TAYLOR WILLARD S & DI  
GRANTEE: TAYLOR REALTY TRUST  
1797/1329 6/07/2012 WD Q I 02 870,000  
GRANTOR: MARSH HAWK ROAD HOLDI  
GRANTEE: TAYLOR WILLARD S SR

BUILDING NOTES	
<p><b>BUILDING DIMENSIONS</b> DCK=[YR=2010] U3 L3 W53 S10 BAS=[YR=1993] S26 BAS=[YR=2010] S9 FGR=[YR=1993] S20 E22N20 W22\$ E9 N7 W6 N2 W3\$ E3 S2 E6 S7 E19 UOP=[YR=1993] E10 N3 W10 S3\$ N3 E10 S5 E15 N11 E3 N27 W16 S7 W20 N6 W20\$ E20 S6 E20 N7 E16 N6\$ PTR= E20 BAL=[YR=2010] E13 S4 FUS=[YR=1993] S17 E20 N18 BAL=[YR=2010] N5 E13 S5 W13\$ E13 S22 W46 N21 E13\$ W13 N4\$ W20 \$.</p>	

EXTRA FEATURES																	
L N	OB/XF CODE	DESCRIPTION	BLD	CAP	L	W	UNITS	UT	Adj R	ADJ UNIT PRICE	ORIG COND	YEAR ON	YEAR ACTUAL	Q	% COND	OB/XF MKT VALUE	NOTES
1	0855	CONC PAVER	0	0	0	0	1,247.00	SF	10.00	10.00	100	2010	2010	3	90	11,223	
2	0504	FP-ELECTRI	0	0	0	0	1.00	UT	2,000.00	2,000.00	100	1988	1988	3	62	1,240	
3	1125	CB/STC 6"	0	0	0	0	84.00	SF	7.35	7.35	100	1988	1988	3	52	321	
4	1125	CB/STC 6"	0	0	0	0	112.00	SF	3.68	3.68	100	1988	1988	3	52	214	
5	0855	CONC PAVER	0	0	0	0	444.00	SF	10.00	10.00	100	2010	2010	3	90	3,996	

LAND DESCRIPTION														TOTAL OB/XF										
L N	USE CODE	CLS	LAND USE DESCRIPTION	CAP	R D	LOC ZONE	FRONT	DEPTH	TOT LND UTS	UNIT TYPE	D T	DPTH FACT	% COND	TOT ADJ	UNIT PRICE	ADJ UNIT PRICE	LAND VALUE	OTHER ADJUSTMENTS AND NOTES	YEAR	DENSITY	DECL	FRZ	YR	CONSRV
1	000140	C	RES GOLF	0	0006	RSF-1	0.00	0.00	1.00	LT		1.00	1.00	1.00	700,000.00	700,000.00	700,000							