

BUILDING CHARACTERISTICS		CONSTRUCTION	
ELEMENT	CD		
Exterior Wall	15	CONC BLOCK	100
Roof Structur	03	GABLE/HIP	100
Roof Cover	02	ROLL COMP	50
Roof Cover	03	COMP SHNGL	50
Interior Wall	04	PLYWOOD	100
Interior Floor	14	CARPET	80
Interior Floor	08	SHT VINYL	20
Air Condition	02	WINDOW	100
Heating Type	02	CONVECTION	100
Bedrooms		3	100
Bathrooms		1	100
Frame	03	MASONRY	100
Stories	1.	1.	100
Units		0	100
BUD8 Adjustme	02	DIST FB	100
Occupancy	00	NONE	100
Quality	02	Quality Level	02
DOR CODE	0100	SINGLE FAMILY	
MAP NUM		MKT AREA	01
NEIGHBORHOOD/LOC	1001.00		
AREA TYPE	TOTAL GROSS AREA	PCT OF BASE	YEAR
BAS	1,400	100	1993
FOP	48	30	1993
TOTALS	1,448		
			1,414
			98,403

MARKET ADJUSTMENTS											
TYPE	MDL	EFF. AREA	TOT ADJ PTS	EFF. BASE RATE	REPL. COST NEW	AYB	EYB	ECON	FNCT	NORM	% COND
0100	01	1,414	86.4500	86.45	122,240	1961	1985	0	0	19.50	80.50
1 SINGLE FAM - 0% - 0 Heated Area: 1400 HX Base Yr											

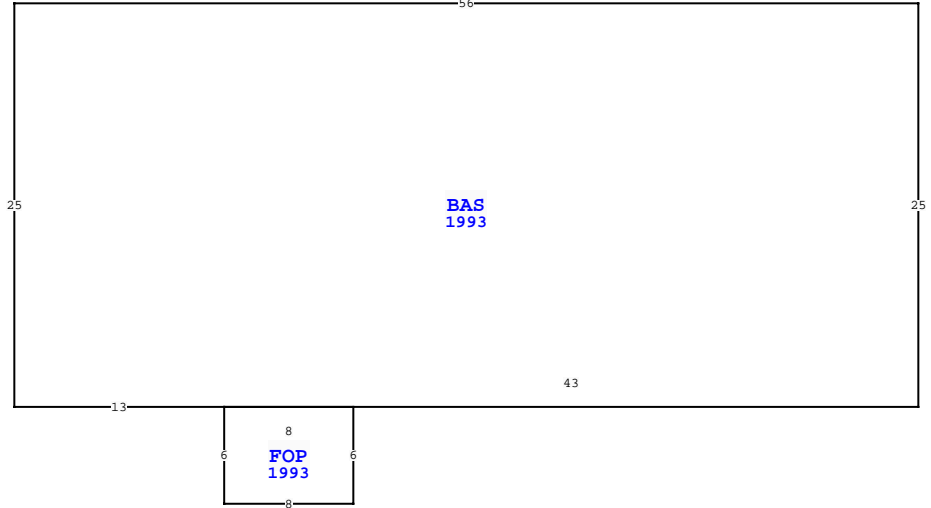

NASSAU COUNTY PROPERTY			
VALUATION SUMMARY			PAGE 1 of 1
VALUATION BY			STANDARD
Tax Group: 2	Tax Dist:		
BUILDING MARKET VALUE			98,403
TOTAL MARKET OB/XF VALUE			0
TOTAL LAND VALUE - MARKET			212,500
TOTAL MARKET VALUE			310,903
SOH/AGL Deduction			147,262
ASSESSED VALUE			163,641
TOTAL EXEMPTION VALUE			0
BASE TAXABLE VALUE			163,641
TOTAL JUST VALUE			310,903
NCON VALUE			0
INCOME VALUE			
PREVIOUS YEAR MKT VALUE			294,067

SALES DATA						
OFF RECORD Number	DATE	TYPE INST	Q U	V I	RSN CD	SALE PRICE
0992/1512	6/19/2001	QC	Q	I	06	100
GRANTOR: WILLIAMS WILLIE W & R						
GRANTEE: WEBSTER TANYA J						

EXTRA FEATURES											
L N	OB/XF CODE	DESCRIPTION	BLD CAP	L	W	UNITS	UT	Adj R	ADJ UNIT PRICE	ORIG COND	YEAR ON

BUILDING NOTES			

BUILDING DIMENSIONS			
BAS=[YR=1993] W56 S25 E13 FOP=[YR=1993] S6 E8 N6W8\$ E43 N25\$			

LAND DESCRIPTION												TOTAL OB/XF												
L N	USE CODE	CLS	LAND USE DESCRIPTION	CAP	R D	LOC ZONE	FRONT	DEPTH	TOT LND UTS	UNIT TYPE	D T	DPHT FACT	% COND	TOT ADJ	UNIT PRICE	ADJ UNIT PRICE	LAND VALUE	OTHER ADJUSTMENTS AND NOTES	YEAR	DENSITY	DECL	FRZ	YR	CONSRV
1	000100	C	RES	0	0006	R-2	50.00	100.00	50.00	FF		1.00	1.00	1.00	4,250.00	4,250.00	212,500							