

| BUILDING CHARACTERISTICS | |
|--------------------------|---------------------|
| ELEMENT | CD |
| Exterior Wall | 16 WD FR STUC 100 |
| Roof Structur | 08 IRREGULAR 100 |
| Roof Cover | 03 COMP SHNGL 100 |
| Interior Wall | 05 DRYWALL 100 |
| Interior Floor | 14 CARPET 80 |
| Interior Floor | 11 CLAY TILE 20 |
| Air Condition | 03 CENTRAL 100 |
| Heating Type | 04 AIR DUCTED 100 |
| Bedrooms | 2 100 |
| Bathrooms | 3.5 100 |
| Frame | 02 WOOD FRAME 100 |
| Stories | 1. 1. 100 |
| Units | 0 100 |
| Occupancy | 00 NONE 100 |
| Quality | 01 Quality Level 01 |
| DOR CODE | 0100 SINGLE FAMILY |
| MAP NUM | MKT AREA 01 |
| NEIGHBORHOOD/LOC | 1044.00 |
| AREA TYPE | TOTAL GROSS AREA |
| BAS | 288 |
| BAS | 2,084 |
| DCK | 450 |
| FEP | 190 |
| FGR | 460 |
| FOP | 78 |
| USP | 205 |
| TOTALS | 3,755 |

| MARKET ADJUSTMENTS | | | | | | | | | | | | | |
|--|-----|-----------|-------------|----------------|----------------|------|------|------|------|-------|--------|--|--|
| TYPE | MDL | EFF. AREA | TOT ADJ PTS | EFF. BASE RATE | REPL. COST NEW | AYB | EYB | ECON | FNCT | NORM | % COND | | |
| 0900 | 01 | 2,907 | 97.7976 | 129.09 | 375,265 | 1996 | 1996 | 0 | 0 | 14.00 | 86.00 | | |
| 1 SNGL FAM - 100% - 1997 Heated Area: 2372 HX Base Yr 1997 | | | | | | | | | | | | | |

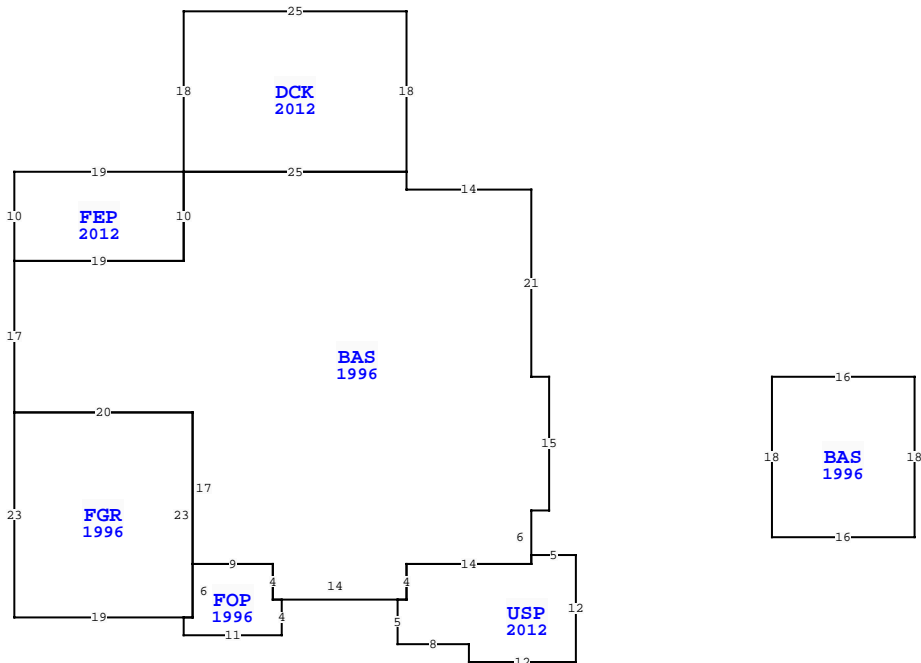

| NASSAU COUNTY PROPERTY | | | |
|---------------------------|-----------|-------------|--|
| VALUATION SUMMARY | | PAGE 1 of 1 | |
| VALUATION BY | STANDARD | | |
| Tax Group: 2 | Tax Dist: | | |
| BUILDING MARKET VALUE | 322,728 | | |
| TOTAL MARKET OB/XF VALUE | 13,246 | | |
| TOTAL LAND VALUE - MARKET | 675,000 | | |
| TOTAL MARKET VALUE | 1,010,974 | | |
| SOH/AGL Deduction | 708,660 | | |
| ASSESSED VALUE | 302,314 | | |
| TOTAL EXEMPTION VALUE | 50,722 | | |
| BASE TAXABLE VALUE | 251,592 | | |
| TOTAL JUST VALUE | 1,010,974 | | |
| NCON VALUE | 0 | | |
| INCOME VALUE | | | |
| PREVIOUS YEAR MKT VALUE | 827,396 | | |

| PERMIT NUM | DESCRIPTION | AMT | ISSUED |
|------------|-------------|--------|------------|
| 20122553 | SCREEN | 2,000 | 12/20/2012 |
| 20122467 | REMODEL | 1,000 | 12/07/2012 |
| 20122447 | WINDOW | 14,000 | 12/06/2012 |
| B9610015 | NEW CONSTR | 97,072 | 09/04/1996 |

| SALES DATA | | | | | | |
|-----------------------------|-----------|-----------|-------|-------|--------|------------|
| OFF RECORD Number | DATE | TYPE INST | Q / U | V / I | RSN CD | SALE PRICE |
| 2373/1219 | 7/01/2020 | WD | U | I | 11 | 100 |
| GRANTOR: TYSON JACQUELINE L | | | | | | |
| GRANTEE: TYSON JACQUELINE L | | | | | | |
| 2337/0617 | 1/20/2020 | WD | P | I | 98 | 100 |
| GRANTOR: TYSON JACQUELINE L | | | | | | |
| GRANTEE: TYSON JACQUELINE L | | | | | | |

| EXTRA FEATURES | | | | | | | | | | | | | | | | |
|----------------|------------|-------------|---------|-----|---|----------|----|-------|----------------|-----------|---------|-------------|---|--------|-----------------|-------|
| L N | OB/XF CODE | DESCRIPTION | BLD CAP | L | W | UNITS | UT | Adj R | ADJ UNIT PRICE | ORIG COND | YEAR ON | YEAR ACTUAL | Q | % COND | OB/XF MKT VALUE | NOTES |
| 1 | 0855 | CONC PAVER | 0 | 100 | 0 | 1,389.00 | SF | 7.00 | 7.00 | 100 | 2014 | 2014 | 3 | 94 | 9,140 | |
| 2 | 1126 | CB/STC 8" | 0 | 100 | 0 | 30.00 | SF | 8.00 | 8.00 | 100 | 1996 | 1996 | 3 | 70 | 168 | |
| 3 | 0911 | SCRN RM A | 0 | 100 | 0 | 450.00 | SF | 17.50 | 17.50 | 100 | 2012 | 2012 | 3 | 50 | 3,938 | |

| BUILDING NOTES | | | |
|----------------|--|------------|--|
| BLD DATE | | | |
| XF DATE | | | |
| INC DATE | | | |
| LGL DATE | | 05/08/2025 | |
| LAND DATE | | MLU | |
| AG DATE | | | |

| BUILDING DIMENSIONS |
|--|
| BAS=[YR=1996] W2 N21 W14 N2 DCK=[YR=2012] N18 W25 S18 E25\$ |
| W25 FEP=[YR=2012] W19 S10 E19 N10 \$ S10 W19 S17 |
| FGR=[YR=1996] S23 E19 FOP=[YR=1996] S2E11 N4 W1 N4 W9 S6 W1 \$ |
| E1 N23W20 \$ E20 S17 E9 S4 E14 USP=[YR=2012] S5 E8 S2 E12 N12 |
| W5 S1 W14 S4 W1\$ E1 N4 E14N6 E2 N15 \$ PTR=E25 BAS=[YR=1996] |
| E16 S18 W16 N18\$ W25\$. |

| LAND DESCRIPTION | | | | | | | | | | | | | | | | | | | | | | | | |
|--------------------|----------|-----|----------------------|-----|-----|----------|--------|-------|-------------|-----------|-----|----------|--------|---------|------------|----------------|------------|-----------------------------|------|---------|------|-----|----|--------|
| TOTAL OB/XF 13,246 | | | | | | | | | | | | | | | | | | | | | | | | |
| L N | USE CODE | CLS | LAND USE DESCRIPTION | CAP | R D | LOC ZONE | FRONT | DEPTH | TOT LND UTS | UNIT TYPE | D T | DPH FACT | % COND | TOT ADJ | UNIT PRICE | ADJ UNIT PRICE | LAND VALUE | OTHER ADJUSTMENTS AND NOTES | YEAR | DENSITY | DECL | FRZ | YR | CONSRV |
| 1 | 000100 | C | RES | 100 | | R-1 | 150.00 | 60.00 | 150.00 | FF | | 1.00 | 1.00 | 0.75 | 6,000.00 | 4,500.00 | 675,000 | | | | | | | |