

| BUILDING CHARACTERISTICS | | CONSTRUCTION | |
|--------------------------|------------------|------------------|------|
| ELEMENT | CD | | |
| Exterior Wall | 05 | AVERAGE 100 | |
| Roof Structur | 03 | GABLE/HIP 100 | |
| Roof Cover | 03 | COMP SHNGL 100 | |
| Interior Wall | 05 | DRYWALL 100 | |
| Interior Floor | 14 | CARPET 70 | |
| Interior Floor | 11 | CLAY TILE 30 | |
| Air Condition | 03 | CENTRAL 100 | |
| Heating Type | 04 | AIR DUCTED 100 | |
| Bedrooms | | 3 100 | |
| Bathrooms | | 2 100 | |
| Frame | 02 | WOOD FRAME 100 | |
| Stories | 1. | 1. 100 | |
| Units | | 0 100 | |
| BUD8 Adjustme | 02 | DIST FB 100 | |
| Occupancy | 00 | NONE 100 | |
| Quality | 06 | Quality Level 06 | |
| DOR CODE | 0100 | SINGLE FAMILY | |
| MAP NUM | | MKT AREA | 01 |
| NEIGHBORHOOD/LOC | | 1046.00 | |
| AREA TYPE | TOTAL GROSS AREA | PCT OF BASE | YEAR |
| BAS | 1,330 | 100 | 1993 |
| FGR | 410 | 55 | 1993 |
| FOP | 25 | 30 | 1993 |
| PTO | 80 | 5 | 1993 |
| TOTALS | 1,845 | | |

| MARKET ADJUSTMENTS | | | | | | | | | | | |
|--|-----|-----------|-------------|----------------|----------------|------|------|------|------|-------|--------|
| TYPE | MDL | EFF. AREA | TOT ADJ PTS | EFF. BASE RATE | REPL. COST NEW | AYB | EYB | ECON | FNCT | NORM | % COND |
| 0100 | 01 | 1,568 | 132.4317 | 132.43 | 207,650 | 1987 | 2000 | 0 | 0 | 11.75 | 88.25 |
| 1 SINGLE FAM - 100% - 2014 Heated Area: 1330 HX Base Yr 2014 | | | | | | | | | | | |

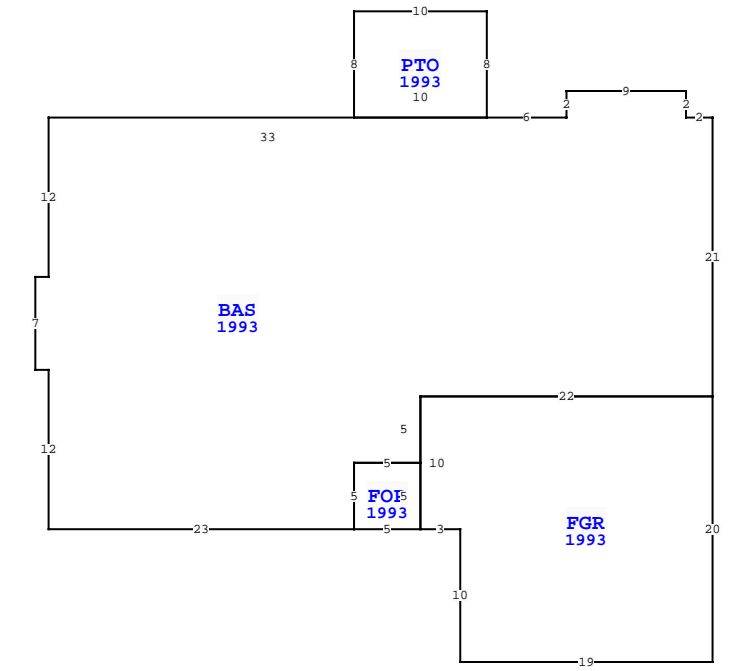

| NASSAU COUNTY PROPERTY | | | |
|---------------------------|-----------|--|-------------|
| VALUATION SUMMARY | | | PAGE 1 of 1 |
| VALUATION BY | | | STANDARD |
| Tax Group: 2 | Tax Dist: | | |
| BUILDING MARKET VALUE | | | 183,251 |
| TOTAL MARKET OB/XF VALUE | | | 4,105 |
| TOTAL LAND VALUE - MARKET | | | 180,000 |
| TOTAL MARKET VALUE | | | 367,356 |
| SOH/AGL Deduction | | | 171,362 |
| ASSESSED VALUE | | | 195,994 |
| TOTAL EXEMPTION VALUE | HX HB | | 50,722 |
| BASE TAXABLE VALUE | | | 145,272 |
| TOTAL JUST VALUE | | | 367,356 |
| NCON VALUE | | | 0 |
| INCOME VALUE | | | |
| PREVIOUS YEAR MKT VALUE | | | 354,354 |

| PERMIT NUM | DESCRIPTION | AMT | ISSUED |
|------------|-------------|-------|------------|
| 20112314 | REPAIR/RRF | 5,000 | 01/02/2012 |

| SALES DATA | | | | | | |
|--------------------------------|-----------|-----------|-------|-------|--------|------------|
| OFF RECORD Number | DATE | TYPE INST | Q / U | V / I | RSN CD | SALE PRICE |
| 1882/0335 | 9/30/2013 | WD Q | Q | I | 02 | 200,000 |
| GRANTOR: TARZIA MICHAEL GEORGE | | | | | | |
| GRANTEE: PYE JAMES R | | | | | | |
| 1796/1560 | 6/06/2012 | WD U | U | I | 30 | 66,500 |
| GRANTOR: TARZIA MICHAEL GEORGE | | | | | | |
| GRANTEE: TARZIA MICHAEL GEORGE | | | | | | |

| EXTRA FEATURES | | | | | | | | | | | | | | | | |
|----------------|------------|-------------|---------|-----|----|--------|----|----------|----------------|-----------|---------|-------------|---|--------|-----------------|-------|
| L N | OB/XF CODE | DESCRIPTION | BLD CAP | L | W | UNITS | UT | Adj R | ADJ UNIT PRICE | ORIG COND | YEAR ON | YEAR ACTUAL | Q | % COND | OB/XF MKT VALUE | NOTES |
| 1 | 0500 | FP-PRE FAB | 0 | 100 | 0 | 1.00 | UT | 3,500.00 | 3,500.00 | 100 | 1987 | 1987 | 3 | 60 | 2,100 | |
| 2 | 0810 | CONCRETE A | 0 | 100 | 20 | 60.00 | SF | 6.50 | 6.50 | 100 | 1987 | 1987 | 3 | 49.5 | 193 | |
| 3 | 0811 | CONCRETE B | 0 | 100 | 44 | 704.00 | SF | 5.20 | 5.20 | 100 | 1987 | 1987 | 3 | 49.5 | 1,812 | |
| TOTALS | | | | | | | | | | | | | | | 4,105 | |

| LAND DESCRIPTION | | | | | | | | | | | | | | | TOTAL OB/XF | | | | | | | | | |
|------------------|----------|-----|----------------------|-----|-----|----------|-------|-------|-------------|-----------|-----|----------|--------|---------|-------------|----------------|------------|-----------------------------|------|---------|------|-----|----|--------|
| L N | USE CODE | CLS | LAND USE DESCRIPTION | CAP | R D | LOC ZONE | FRONT | DEPTH | TOT LND UTS | UNIT TYPE | D T | DPH FACT | % COND | TOT ADJ | UNIT PRICE | ADJ UNIT PRICE | LAND VALUE | OTHER ADJUSTMENTS AND NOTES | YEAR | DENSITY | DECL | FRZ | YR | CONSRV |
| 1 | 000100 | C | RES | 100 | | R-1 | 0.00 | 0.00 | 1.00 | LT | | 1.00 | 1.00 | 1.00 | 180,000.00 | 180,000.00 | 180,000 | | | | | | | |