

BUILDING CHARACTERISTICS		
ELEMENT	CD	CONSTRUCTION
Exterior Wall	20	FACE BRICK 100
Roof Structur	03	GABLE/HIP 100
Roof Cover	03	COMP SHNGL 100
Interior Wall	05	DRYWALL 100
Interior Floo	14	CARPET 80
Interior Floo	11	CLAY TILE 20
Air Condition	03	CENTRAL 100
Heating Type	04	AIR DUCTED 100
Bedrooms		3 100
Bathrooms		2 100
Frame	02	WOOD FRAME 100
Stories	1.	1. 100
Units		0 100
BUD8 Adjustme	02	DIST FB 100
Occupancy	00	NONE 100

MARKET ADJUSTMENTS													
TYPE	MDL	EFF. AREA	TOT ADJ PTS	EFF. BASE RATE	REPL. COST NEW	AYB	EYB	ECON	FNCT	NORM	% COND		
0900	01	1,832	129.4900	170.93	313,144	1987	1987	0	0	26.35	73.65		
1 SNGL FAM - 0% - 0 Heated Area: 1529 HX Base Yr													

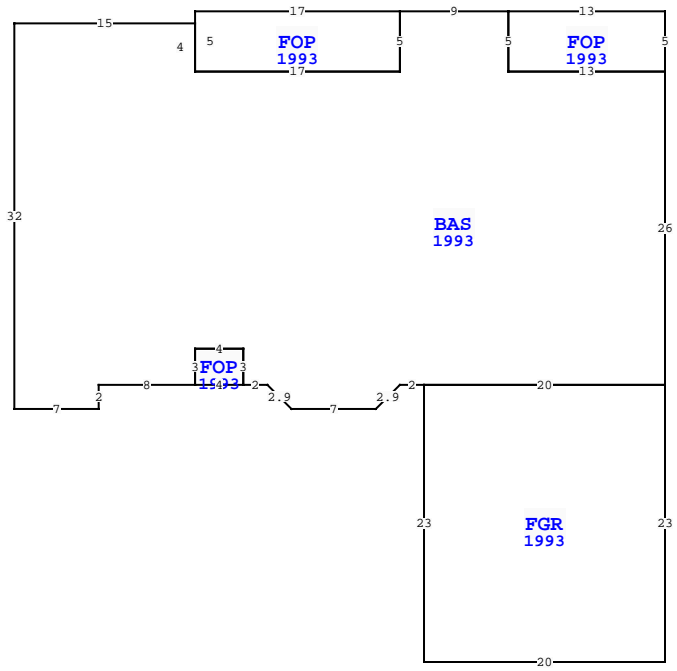

Quality	06	Quality Level 06			
DOR CODE	0100	SINGLE FAMILY			
MAP NUM		MKT AREA 01			
NEIGHBORHOOD/LOC	1046.00				
AREA TYPE	TOTAL GROSS AREA	PCT OF BASE	YEAR	TOT ADJ AREA	SUBAREA MARKET VALUE
BAS	1,529	100	1993	1,529	192,486
FGR	460	55	1993	253	31,850
FOP	12	30	1993	4	504
FOP	65	30	1993	20	2,518
FOP	85	30	1993	26	3,273
TOTALS	2,151			1,832	230,631

NASSAU COUNTY PROPERTY			
VALUATION SUMMARY			PAGE 1 of 1
VALUATION BY			STANDARD
Tax Group: 2	Tax Dist:		
BUILDING MARKET VALUE			230,631
TOTAL MARKET OB/XF VALUE			4,347
TOTAL LAND VALUE - MARKET			180,000
TOTAL MARKET VALUE			414,978
SOH/AGL Deduction			79,409
ASSESSED VALUE			335,569
TOTAL EXEMPTION VALUE			0
BASE TAXABLE VALUE			335,569
TOTAL JUST VALUE			414,978
NCON VALUE			0
INCOME VALUE			
PREVIOUS YEAR MKT VALUE			389,984

PERMIT NUM	DESCRIPTION	AMT	ISSUED
20120506	H/AC	4,400	03/27/2012
20120112	WTR HTR	900	01/23/2012
20120026	UG CATV	0	01/09/2012
4466	NEW CONSTR	38,000	09/09/1987

SALES DATA						
OFF RECORD Number	DATE	TYPE INST	Q / U	V / I	RSN CD	SALE PRICE
1435/1115	8/07/2006	QC	Q	I	01	100
GRANTOR: RANK STEVE M & ELDEM						
GRANTEE: THE STEVEN & ELDEM						
0756/0789	4/09/1996	WD	Q	I		97,700
GRANTOR: SECRETARY OF VETERANS						
GRANTEE: RANK STEVE M & ELDE						

EXTRA FEATURES																
L N	OB/XF CODE	DESCRIPTION	BLD CAP	L	W	UNITS	UT	Adj R	ADJ UNIT PRICE	ORIG COND	YEAR ON	YEAR ACTUAL	Q	% COND	OB/XF MKT VALUE	NOTES
1	0500	FP-PRE FAB	0	0	0	1.00	UT	3,500.00	3,500.00	100	1987	1987	3	60	2,100	
2	0811	CONCRETE B	0	0	39	741.00	SF	5.20	5.20	100	1987	1987	3	49.5	1,907	
3	0811	CONCRETE B	0	0	44	132.00	SF	5.20	5.20	100	1987	1987	3	49.5	340	

BUILDING NOTES			

BUILDING DIMENSIONS			
FOP=[YR=1993] W13 BAS=[YR=1993] W9 FOP=[YR=1993] W17 S5 E17 N5 \$ S5 W17 N4 W15 S32 E7 N2 E8 FOP=[YR=1993] E4 N3 W4 S3 \$ N3 E4 S3 E2 D2 R2 E7 U2 R2 E2 FGR=[YR=1993] S23 E20 N23 W20 \$ E20 N26 W13 N5 \$ S5 E13 N5 \$.			

LAND DESCRIPTION														TOTAL OB/XF										
L N	USE CODE	CLS	LAND USE DESCRIPTION	CAP	R D	LOC ZONE	FRONT	DEPTH	TOT LND UTS	UNIT TYPE	D T	DPH FACT	% COND	TOT ADJ	UNIT PRICE	ADJ UNIT PRICE	LAND VALUE	OTHER ADJUSTMENTS AND NOTES	YEAR	DENSITY	DECL	FRZ	YR	CONSRV
1	000100	C	RES	0		R-1	0.00	0.00	1.00	LT		1.00	1.00	1.00	180,000.00	180,000.00	180,000							