

| BUILDING CHARACTERISTICS |                  | CONSTRUCTION         |         |
|--------------------------|------------------|----------------------|---------|
| ELEMENT                  | CD               |                      |         |
| Exterior Wall            | 16               | WD FR STUC           | 100     |
| Roof Structur            | 03               | GABLE/HIP            | 100     |
| Roof Cover               | 03               | COMP SHNGL           | 100     |
| Interior Wall            | 05               | DRYWALL              | 100     |
| Interior Floo            | 14               | CARPET               | 70      |
| Interior Floo            | 11               | CLAY TILE            | 30      |
| Air Condition            | 03               | CENTRAL              | 100     |
| Heating Type             | 04               | AIR DUCTED           | 100     |
| Bedrooms                 |                  | 4                    | 100     |
| Bathrooms                |                  | 3                    | 100     |
| Frame                    | 02               | WOOD FRAME           | 100     |
| Stories                  | 1.               | 1.                   | 100     |
| Units                    |                  | 0                    | 100     |
| Occupancy                | 00               | NONE                 | 100     |
| Quality                  | 03               | Quality Level 03     |         |
| DOR CODE                 | 0100             | SINGLE FAMILY        |         |
| MAP NUM                  |                  | MKT AREA             | 01      |
| NEIGHBORHOOD/LOC         | 1079.00          |                      |         |
| AREA TYPE                | TOTAL GROSS AREA | PCT OF BASE          | YEAR    |
| BAS                      | 2,626            | 100                  | 2006    |
| FGR                      | 480              | 55                   | 2006    |
| FOP                      | 105              | 30                   | 2006    |
| FSP                      | 200              | 40                   | 2013    |
| TOTALS                   | 3,411            |                      |         |
|                          |                  | TOT ADJ AREA         | 3,002   |
|                          |                  | SUBAREA MARKET VALUE | 493,148 |

| MARKET ADJUSTMENTS           |          |           |             |                |                |     |     |      |      |      |        |  |
|------------------------------|----------|-----------|-------------|----------------|----------------|-----|-----|------|------|------|--------|--|
| TYPE                         | MDL      | EFF. AREA | TOT ADJ PTS | EFF. BASE RATE | REPL. COST NEW | AYB | EYB | ECON | FNCT | NORM | % COND |  |
| 1                            | SFR CUST | - 0%      | - 0         |                |                |     |     |      |      |      |        |  |
| Heated Area: 2626 HX Base Yr |          |           |             |                |                |     |     |      |      |      |        |  |

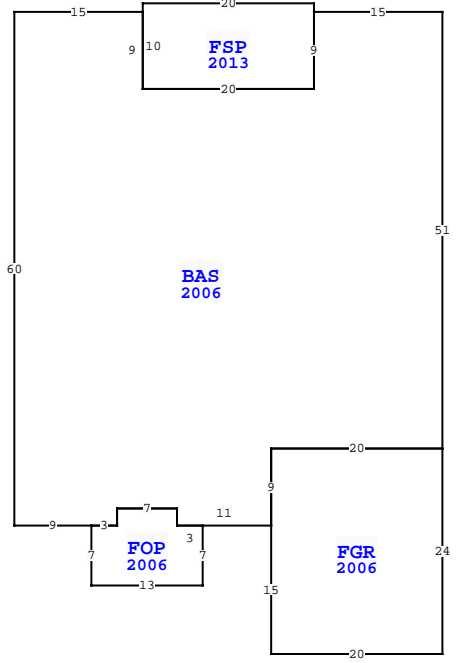

| NASSAU COUNTY PROPERTY    |           | PAGE 1 of 1 | 2        |
|---------------------------|-----------|-------------|----------|
| VALUATION SUMMARY         |           |             |          |
| VALUATION BY              |           |             | STANDARD |
| Tax Group: 2              | Tax Dist: |             |          |
| BUILDING MARKET VALUE     |           |             | 493,148  |
| TOTAL MARKET OB/XF VALUE  |           |             | 13,552   |
| TOTAL LAND VALUE - MARKET |           |             | 150,000  |
| TOTAL MARKET VALUE        |           |             | 656,700  |
| SOH/AGL Deduction         |           |             | 84,783   |
| ASSESSED VALUE            |           |             | 571,917  |
| TOTAL EXEMPTION VALUE     |           |             | 0        |
| BASE TAXABLE VALUE        |           |             | 571,917  |
| TOTAL JUST VALUE          |           |             | 656,700  |
| NCON VALUE                |           |             | 0        |
| INCOME VALUE              |           |             |          |
| PREVIOUS YEAR MKT VALUE   |           |             | 634,944  |

| PERMIT NUM | DESCRIPTION | AMT     | ISSUED     |
|------------|-------------|---------|------------|
| 20061661   | OTHER       | 1,640   | 07/12/2006 |
| 20060973   | H/AC        | 7,200   | 05/08/2006 |
| 20060919   | ELEC OTHER  | 4,980   | 04/28/2006 |
| 20060586   | OTHER       | 7,356   | 03/21/2006 |
| 20060510   | DEMOLITION  | 0       | 03/14/2006 |
| 20060321   | NEW CONSTR  | 250,000 | 02/09/2006 |

| SALES DATA                     |            |           |           |        |            |  |
|--------------------------------|------------|-----------|-----------|--------|------------|--|
| OFF RECORD Number              | DATE       | TYPE INST | Q / V / I | RSN CD | SALE PRICE |  |
| 2253/0261                      | 1/31/2019  | WD Q      | Q I       | 01     | 465,000    |  |
| GRANTOR: DAVENPORT RONALD K &  |            |           |           |        |            |  |
| GRANTEE: HURST PAUL KENNETH    |            |           |           |        |            |  |
| 1450/1531                      | 10/09/2006 | WD Q      | Q I       |        | 477,600    |  |
| GRANTOR: SEDA CONSTRUCTION COM |            |           |           |        |            |  |
| GRANTEE: DAVENPORT RONALD K    |            |           |           |        |            |  |

| EXTRA FEATURES |            |             |         |   |     |          |    |          |                |           |         |             |        |        |                 |       |
|----------------|------------|-------------|---------|---|-----|----------|----|----------|----------------|-----------|---------|-------------|--------|--------|-----------------|-------|
| L N            | OB/XF CODE | DESCRIPTION | BLD CAP | L | W   | UNITS    | UT | Adj R    | ADJ UNIT PRICE | ORIG COND | YEAR ON | YEAR ACTUAL | Q      | % COND | OB/XF MKT VALUE | NOTES |
| 1              | 0504       | FP-ELECTRI  | 0       | 0 | 0   | 1.00     | UT | 2,000.00 | 2,000.00       | 100       | 2006    | 2006        | 3      | 89     | 1,780           |       |
| 2              | 0855       | CONC PAVER  | 0       | 0 | 0   | 541.00   | SF | 10.00    | 10.00          | 100       | 2006    | 2006        | 3      | 86     | 4,653           |       |
| 3              | 0855       | CONC PAVER  | 0       | 0 | 30  | 90.00    | SF | 10.00    | 10.00          | 100       | 2006    | 2006        | 3      | 86     | 774             |       |
| 4              | 0462       | ST/AL FNC   | 0       | 0 | 337 | 1,348.00 | SF | 10.00    | 10.00          | 100       | 2007    | 2007        | 3      | 44     | 5,931           |       |
| 5              | 0463       | FENCE GATE  | 0       | 0 | 0   | 2.00     | UT | 300.00   | 300.00         | 100       | 2007    | 2007        | 3      | 69     | 414             |       |
| TOTALS         |            |             |         |   |     |          |    |          |                |           |         |             | 13,552 |        |                 |       |

| LAND DESCRIPTION |          |     |                      |     |      |          |       |       |             |           |     |          | TOTAL OB/XF |         |            |                |            |                             |      |         |      |     |    |        |  |
|------------------|----------|-----|----------------------|-----|------|----------|-------|-------|-------------|-----------|-----|----------|-------------|---------|------------|----------------|------------|-----------------------------|------|---------|------|-----|----|--------|--|
| L N              | USE CODE | CLS | LAND USE DESCRIPTION | CAP | R D  | LOC ZONE | FRONT | DEPTH | TOT LND UTS | UNIT TYPE | D T | DPH FACT | % COND      | TOT ADJ | UNIT PRICE | ADJ UNIT PRICE | LAND VALUE | OTHER ADJUSTMENTS AND NOTES | YEAR | DENSITY | DECL | FRZ | YR | CONSRV |  |
| 1                | 000100   | C   | RES                  | 0   | 0003 | R-1      | 0.00  | 0.00  | 1.00        | LT        |     | 1.00     | 1.00        | 1.00    | 150,000.00 | 150,000.00     | 150,000    |                             |      |         |      |     |    |        |  |