

| BUILDING CHARACTERISTICS | | CONSTRUCTION | |
|--------------------------|------------------|---------------|--------------|
| ELEMENT | CD | | |
| Exterior Wall | 10 | ABOVE AVG | 100 |
| Roof Structur | 03 | GABLE/HIP | 100 |
| Roof Cover | 03 | COMP SHNGL | 100 |
| Interior Wall | 05 | DRYWALL | 100 |
| Interior Floo | 11 | CLAY TILE | 100 |
| Air Condition | 03 | CENTRAL | 100 |
| Heating Type | 04 | AIR DUCTED | 100 |
| Bedrooms | | 2 | 100 |
| Bathrooms | | 2 | 100 |
| Frame | 02 | WOOD FRAME | 100 |
| Stories | 1. | 1. | 100 |
| Units | | 0 | 100 |
| BUD8 Adjustme | 06 | DIST 1D | 100 |
| Occupancy | 00 | NONE | 100 |
| Quality | 01 | Quality Level | 01 |
| DOR CODE | 0100 | SINGLE FAMILY | |
| MAP NUM | | MKT AREA | 08 |
| NEIGHBORHOOD/LOC | 8026.00 | | |
| AREA TYPE | TOTAL GROSS AREA | PCT OF BASE | TOT ADJ AREA |
| BAS | 1,737 | 100 | 1,737 |
| DCK | 306 | 10 | 31 |
| FOP | 60 | 30 | 18 |
| FOP | 78 | 30 | 23 |
| FOP | 108 | 30 | 32 |
| UGR | 471 | 45 | 212 |
| USP | 240 | 30 | 72 |
| TOTALS | 3,000 | | 2,125 |

| MARKET ADJUSTMENTS | | | | | | | | | | | |
|--|-----|-----------|-------------|----------------|----------------|------|------|------|------|-------|--------|
| TYPE | MDL | EFF. AREA | TOT ADJ PTS | EFF. BASE RATE | REPL. COST NEW | AYB | EYB | ECON | FNCT | NORM | % COND |
| 0900 | 01 | 2,125 | 107.6040 | 134.50 | 285,812 | 1988 | 1995 | 0 | 0 | 13.50 | 86.50 |
| 1 SNGL FAM - 100% - 2007 Heated Area: 1737 HX Base Yr 2007 | | | | | | | | | | | |

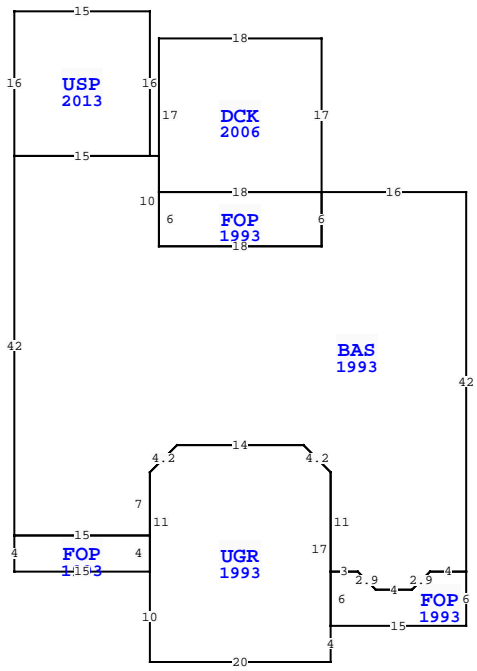

| NASSAU COUNTY PROPERTY | | PAGE 1 of 1 | 6 |
|---------------------------|-----------|-------------|---------|
| VALUATION SUMMARY | | | |
| VALUATION BY | STANDARD | | |
| Tax Group: 6 | Tax Dist: | | |
| BUILDING MARKET VALUE | | | 247,227 |
| TOTAL MARKET OB/XF VALUE | | | 5,747 |
| TOTAL LAND VALUE - MARKET | | | 57,600 |
| TOTAL MARKET VALUE | | | 310,574 |
| SOH/AGL Deduction | | | 174,269 |
| ASSESSED VALUE | | | 136,305 |
| TOTAL EXEMPTION VALUE | HX HB | | 50,000 |
| BASE TAXABLE VALUE | | | 86,305 |
| TOTAL JUST VALUE | | | 310,574 |
| NCON VALUE | | | 0 |
| INCOME VALUE | | | |
| PREVIOUS YEAR MKT VALUE | | | 299,908 |

| PERMIT NUM | DESCRIPTION | AMT | ISSUED |
|------------|-------------|--------|------------|
| 18005003 | REPAIR/RRF | 6,683 | 06/01/2018 |
| B1327207 | REPAIR/RRF | 0 | 05/01/2013 |
| 3261 | NEW CONSTR | 0 | 10/26/1988 |
| 5464 | NEW CONSTR | 3,200 | 10/25/1988 |
| 5213 | NEW CONSTR | 59,229 | 10/10/1988 |

| SALES DATA | | | | | | |
|--------------------------------|-----------|-----------|-------|-------|--------|------------|
| OFF RECORD Number | DATE | TYPE INST | Q / U | V / I | RSN CD | SALE PRICE |
| 1403/1114 | 4/12/2006 | WD Q | Q | I | | 219,000 |
| GRANTOR: MULLINIKS PATRICK & S | | | | | | |
| GRANTEE: HATFIELD THERESA A | | | | | | |
| 0756/1726 | 4/12/1996 | WD Q | Q | I | | 90,000 |
| GRANTOR: THOMPSON BETTIE J | | | | | | |
| GRANTEE: MULLINIKS PATRICK J | | | | | | |

| EXTRA FEATURES | | | | | | | | | | | | | | | | |
|----------------|------------|-------------|---------|-----|----|--------|----|----------|----------------|-----------|---------|-------------|---|--------|-----------------|-------|
| L N | OB/XF CODE | DESCRIPTION | BLD CAP | L | W | UNITS | UT | Adj R | ADJ UNIT PRICE | ORIG COND | YEAR ON | YEAR ACTUAL | Q | % COND | OB/XF MKT VALUE | NOTES |
| 1 | 0811 | CONCRETE B | 0 | 100 | 0 | 528.00 | SF | 5.20 | 5.20 | 100 | 1988 | 1988 | 3 | 54.5 | 1,496 | |
| 2 | 0681 | POLE SHED | 0 | 100 | 36 | 432.00 | SF | 15.00 | 15.00 | 100 | 2006 | 2006 | 3 | 44 | 2,851 | |
| 3 | 9001 | CONTANR 40 | 0 | 100 | 0 | 1.00 | UT | 1,400.00 | 1,400.00 | 100 | 2004 | 2004 | 3 | 100 | 1,400 | |

| BUILDING NOTES | |
|----------------|--|
| | |

| BUILDING DIMENSIONS | |
|--|--|
| BAS=[YR=1993] W16 DCK=[YR=2006] N17 W18 S17 FOP=[YR=1993] S6 E18 N6 W18\$ E18\$ S6 W18 N10 W1 USP=[YR=2013] N16 W15 S16 E15\$ W15 S42 FOP=[YR=1993] S4 E15 UGR=[YR=1993] S10 E20 N4 FOP=[YR=1993] E15 N6 W4 D2 L2 W4 U2 L2 W3 S6\$ N17 U3 L3 W14 D3 L3 S11\$ N4 W15\$ E15 N7 U3 R3 E14 D3 R3 S11 E3 D2 R2 E4 U2 R2 E4 N42\$. | |

| LAND DESCRIPTION | | | | | | | | | | | | | | | TOTAL OB/XF | | | | | | | | | |
|------------------|----------|-----|----------------------|-----|------|----------|-------|-------|-------------|-----------|-----|----------|--------|---------|-------------|----------------|------------|-----------------------------|------|---------|------|-----|----|--------|
| L N | USE CODE | CLS | LAND USE DESCRIPTION | CAP | R D | LOC ZONE | FRONT | DEPTH | TOT LND UTS | UNIT TYPE | D T | DPH FACT | % COND | TOT ADJ | UNIT PRICE | ADJ UNIT PRICE | LAND VALUE | OTHER ADJUSTMENTS AND NOTES | YEAR | DENSITY | DECL | FRZ | YR | CONSRV |
| 1 | 000115 | C | SFR ACRES | 100 | 0005 | OR | 0.00 | 0.00 | 3.20 | AC | | 1.00 | 1.00 | 1.00 | 18,000.00 | 18,000.00 | 57,600 | | | | | | | |