

| BUILDING CHARACTERISTICS |                  | CONSTRUCTION     |              |
|--------------------------|------------------|------------------|--------------|
| ELEMENT                  | CD               |                  |              |
| Exterior Wall            | 16               | WD FR STUC       | 100          |
| Roof Structur            | 08               | IRREGULAR        | 100          |
| Roof Cover               | 03               | COMP SHNGL       | 100          |
| Interior Wall            | 05               | DRYWALL          | 100          |
| Interior Floo            | 14               | CARPET           | 70           |
| Interior Floo            | 11               | CLAY TILE        | 30           |
| Air Condition            | 03               | CENTRAL          | 100          |
| Heating Type             | 04               | AIR DUCTED       | 100          |
| Bedrooms                 |                  | 4                | 100          |
| Bathrooms                |                  | 2                | 100          |
| Frame                    | 02               | WOOD FRAME       | 100          |
| Stories                  | 1.               | 1.               | 100          |
| Units                    |                  | 0                | 100          |
| Occupancy                | 00               | NONE             | 100          |
| Quality                  | 03               | Quality Level 03 |              |
| DOR CODE                 | 0100             | SINGLE FAMILY    |              |
| MAP NUM                  |                  | MKT AREA         | 04           |
| NEIGHBORHOOD/LOC         | 4077.00          |                  |              |
| AREA TYPE                | TOTAL GROSS AREA | PCT OF BASE      | TOT ADJ AREA |
| BAS                      | 2,376            | 100              | 2,376        |
| FGR                      | 747              | 55               | 411          |
| FOP                      | 52               | 30               | 16           |
| FOP                      | 216              | 30               | 65           |
| TOTALS                   | 3,391            |                  | 2,868        |
|                          |                  |                  | 350,689      |

| MARKET ADJUSTMENTS |          |           |             |                |                |                 |     |      |      |      |        |
|--------------------|----------|-----------|-------------|----------------|----------------|-----------------|-----|------|------|------|--------|
| TYPE               | MDL      | EFF. AREA | TOT ADJ PTS | EFF. BASE RATE | REPL. COST NEW | AYB             | EYB | ECON | FNCT | NORM | % COND |
| 1                  | SNGL FAM | - 100%    | - 2010      |                |                |                 |     |      |      |      |        |
| Heated Area: 2376  |          |           |             |                |                | HX Base Yr 2010 |     |      |      |      |        |

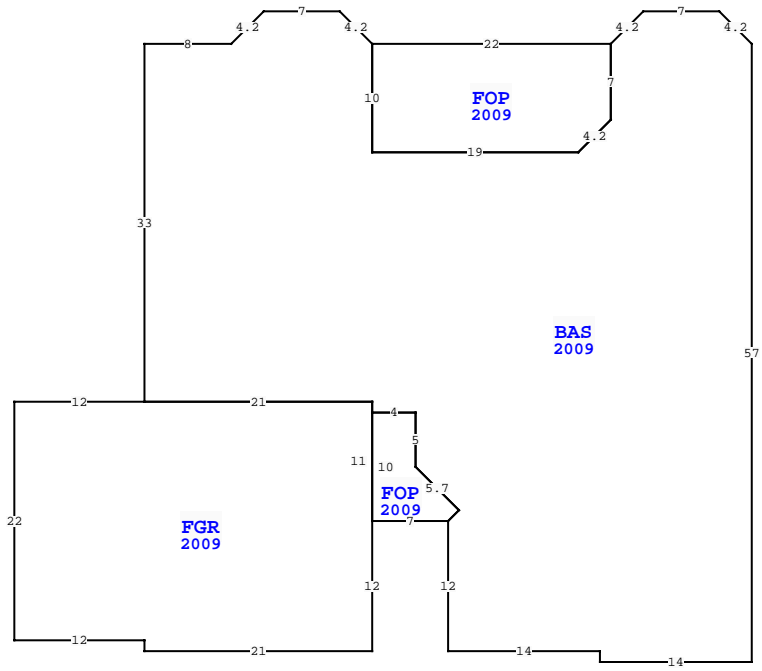

| NASSAU COUNTY PROPERTY    |  | PAGE 1 of 1 | 4 |
|---------------------------|--|-------------|---|
| VALUATION SUMMARY         |  |             |   |
| VALUATION BY              |  | STANDARD    |   |
| Tax Group: 4              |  | Tax Dist:   |   |
| BUILDING MARKET VALUE     |  | 350,689     |   |
| TOTAL MARKET OB/XF VALUE  |  | 11,128      |   |
| TOTAL LAND VALUE - MARKET |  | 75,000      |   |
| TOTAL MARKET VALUE        |  | 436,817     |   |
| SOH/AGL Deduction         |  | 211,050     |   |
| ASSESSED VALUE            |  | 225,767     |   |
| TOTAL EXEMPTION VALUE     |  | 50,000      |   |
| BASE TAXABLE VALUE        |  | 175,767     |   |
| TOTAL JUST VALUE          |  | 436,817     |   |
| NCON VALUE                |  | 0           |   |
| INCOME VALUE              |  |             |   |
| PREVIOUS YEAR MKT VALUE   |  | 421,474     |   |

| PERMIT NUM | DESCRIPTION | AMT     | ISSUED     |
|------------|-------------|---------|------------|
| C22240     | CO ISSUED   | 0       | 05/14/2009 |
| E21586     | ELEC OTHER  | 2,000   | 02/01/2009 |
| M14389     | MECH OTHER  | 0       | 02/01/2009 |
| P13652     | OTHER       | 0       | 02/01/2009 |
| B22240     | NEW CONSTR  | 219,516 | 01/01/2009 |
| R11733     | REPAIR/RRF  | 5,660   | 01/01/2009 |

| SALES DATA        |           |           |       |       |        |            |
|-------------------|-----------|-----------|-------|-------|--------|------------|
| OFF RECORD Number | DATE      | TYPE INST | Q / U | V / I | RSN CD | SALE PRICE |
| 1622/0522         | 5/29/2009 | WD Q      | Q     | I     | 01     | 265,197    |

GRANTOR: WOODSIDE AMELIA LAKES  
GRANTEE: CREWS JUSTIN & ASHL

| BUILDING NOTES  |  |
|---|--|
|   |  |
| BUILDING DIMENSIONS   |  |
| BAS=[YR=2009] U3 L3 W7 D3 L3 FOP=[YR=2009] W22 S10 E19 U3 R3 N7 \$ S7 L3 D3 W19 N10 U3 L3 W7 D3 L3 W8 S33 FGR=[YR=2009] W12 S22 E12 S1 E21 N12 FOP=[YR=2009] E7 U1 R1 U4 L4 N5 W4 S10 \$ N11 W21 \$ E21 S1 E4 S5 D4 R4 D1 L1 S12 E14 S1 E14 N57 \$. |  |

| EXTRA FEATURES |            |             |         |     |   |          |    |       |                |           |         |             |   |        |                 |       |
|----------------|------------|-------------|---------|-----|---|----------|----|-------|----------------|-----------|---------|-------------|---|--------|-----------------|-------|
| L N            | OB/XF CODE | DESCRIPTION | BLD CAP | L   | W | UNITS    | UT | Adj R | ADJ UNIT PRICE | ORIG COND | YEAR ON | YEAR ACTUAL | Q | % COND | OB/XF MKT VALUE | NOTES |
| 1              | 0812       | CONCRETE C  | 0       | 100 | 0 | 1,366.00 | UT | 4.00  | 4.00           | 100       | 2009    | 2009        | 3 | 90     | 4,918           |       |
| 2              | 0462       | ST/AL FNC   | 0       | 100 | 0 | 792.00   | SF | 10.00 | 10.00          | 100       | 2009    | 2009        | 3 | 56     | 4,435           |       |
| 3              | 0810       | CONCRETE A  | 0       | 100 | 0 | 300.00   | SF | 6.50  | 6.50           | 100       | 2010    | 2010        | 3 | 91     | 1,775           |       |

| LAND DESCRIPTION |          | TOTAL OB/XF |                      |     |     |          |       |       |             |           |   |          |        |         |            |                |            |                             |      |         |      |     |    |        |
|------------------|----------|-------------|----------------------|-----|-----|----------|-------|-------|-------------|-----------|---|----------|--------|---------|------------|----------------|------------|-----------------------------|------|---------|------|-----|----|--------|
| L N              | USE CODE | CLS         | LAND USE DESCRIPTION | CAP | R D | LOC ZONE | FRONT | DEPTH | TOT LND UTS | UNIT TYPE | D | DPH FACT | % COND | TOT ADJ | UNIT PRICE | ADJ UNIT PRICE | LAND VALUE | OTHER ADJUSTMENTS AND NOTES | YEAR | DENSITY | DECL | FRZ | YR | CONSRV |
| 1                | 000135   | C           | SFR CNSVTN           | 100 |     | PUD      | 0.00  | 0.00  | 1.00        | LT        |   | 1.00     | 1.00   | 1.00    | 75,000.00  | 75,000.00      | 75,000     |                             |      |         |      |     |    |        |