

LOT 45
IN OR 1323/1788
ESMT OR 989/239

HAGERMAN JAMES A SR & DIMPNA
86020 WORTHINGTON DRIVE
YULEE, FL 32097

2023

51-3N-27-1625-0045-0000



BUILDING CHARACTERISTICS		CONSTRUCTION	
ELEMENT	CD		
Exterior Wall	20	FACE BRICK	100
Roof Structur	03	GABLE/HIP	100
Roof Cover	03	COMP SHNGL	100
Interior Wall	05	DRYWALL	100
Interior Floo	14	CARPET	70
Interior Floo	11	CLAY TILE	30
Air Condition	03	CENTRAL	100
Heating Type	04	AIR DUCTED	100
Bedrooms		3	100
Bathrooms		2	100
Frame	02	WOOD FRAME	100
Stories	1.	1.	100
Units		0	100
Occupancy	00	NONE	100
Quality	05	Quality Level	05
DOR CODE	0100	SINGLE FAMILY	
MAP NUM		MKT AREA	04
NEIGHBORHOOD/LOC	4039.00		
AREA TYPE	TOTAL GROSS AREA	PCT OF BASE	TOT ADJ AREA
BAS	1,680	100	1,680
FGR	462	55	254
FOP	12	30	4
FSP	180	40	72
STP	16	10	2
TOTALS	2,350		2,012
			192,821

MARKET ADJUSTMENTS													
TYPE	MDL	EFF. AREA	TOT ADJ PTS	EFF. BASE RATE	REPL. COST NEW	AYB	EYB	ECON	FNCT	NORM	% COND		
1												1 SINGLE FAM - 100% - 2006	
												Heated Area: 1680	
												HX Base Yr	

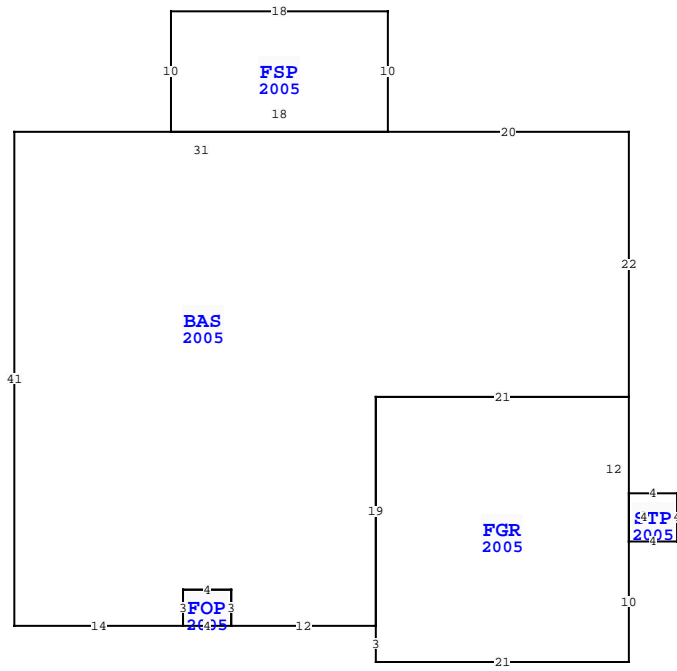

NASSAU COUNTY PROPERTY			
VALUATION SUMMARY			PAGE 1 of 1
VALUATION BY			STANDARD
Tax Group: 4	Tax Dist:		
BUILDING MARKET VALUE			192,821
TOTAL MARKET OB/XF VALUE			19,831
TOTAL LAND VALUE - MARKET			80,000
TOTAL MARKET VALUE			292,652
SOH/AGL Deduction			0
ASSESSED VALUE			292,652
TOTAL EXEMPTION VALUE	13		292,652
BASE TAXABLE VALUE			0
TOTAL JUST VALUE			292,652
NCON VALUE			0
INCOME VALUE			
PREVIOUS YEAR MKT VALUE			227,884

PERMIT NUM	DESCRIPTION	AMT	ISSUED
17008755	REPAIR/RRF	22,000	10/04/2017
B23178	FOUNDATION	1,000	01/01/2010
E18916	ELEC OTHER	200	03/01/2007
B16684	GARAGE	5,895	11/01/2005
E0413975	ELEC OTHER	2,000	12/01/2004
M0409044	H/AC	0	12/01/2004

SALES DATA						
OFF RECORD Number	DATE	TYPE INST	Q / U	V / I	RSN CD	SALE PRICE
1323/1788	6/08/2005	WD	Q	I		172,600
GRANTOR: RICHMOND AMERICAN HOM						
GRANTEE: HAGERMAN JAMES A SR						
1259/1936	9/17/2004	WD	U	V	19	1,950,400
GRANTOR: WATSON HOME BUILDERS						
GRANTEE: RICHMOND AMERICAN H						

EXTRA FEATURES																
L N	OB/XF CODE	DESCRIPTION	BLD CAP	L	W	UNITS	UT	Adj R	ADJ UNIT PRICE	ORIG COND	YEAR ON	YEAR ACTUAL	Q	% COND	OB/XF MKT VALUE	NOTES
1	0811	CONCRETE B	0	100	0	0			781.00	5.20	100	2005	2005	3	87	3,533
3	0940	SHEDS/PORT	0	100	33	11	SF	30.00	30.00	100	2005	2005	3	27	2,940	
4	0511	GARAGE CB-	0	100	33	11	SF	40.00	40.00	100	2010	2010	3	92	13,358	

TOTAL OB/XF														
														19,831
86020 WORTHINGTON DR, YULEE														
BLD DATE														
XF DATE														
INC DATE														
LGL DATE														
LAND DATE														
AG DATE														

BUILDING NOTES													

BUILDING DIMENSIONS													
BAS=[YR=2005] W20 FSP=[YR=2005] N10 W18 S10 E18\$ W31 S41 E14													
FOP=[YR=2005] E4 N3 W4 S3\$ N3 E4 S3 E12 FGR=[YR=2005] S3 E21													
N10 STP=[YR=2005] E4 N4 W4 S4\$ N12 W21 S19\$ N19 E21 N22\$.													

LAND DESCRIPTION														TOTAL OB/XF										
L N	USE CODE	CLS	LAND USE DESCRIPTION	CAP	R D	LOC ZONE	FRONT	DEPTH	TOT LND UTS	UNIT TYPE	D T	DPH FACT	% COND	TOT ADJ	UNIT PRICE	ADJ UNIT PRICE	LAND VALUE	OTHER ADJUSTMENTS AND NOTES	YEAR	DENSITY	DECL	FRZ	YR	CONSRV
1	000100	C	SFR	100	0003	OR	0.00	0.00	1.00	LT		1.00	1.00	1.00	80,000.00	80,000.00	80,000							