

| BUILDING CHARACTERISTICS |                  | CONSTRUCTION  |              |
|--------------------------|------------------|---------------|--------------|
| ELEMENT                  | CD               |               |              |
| Exterior Wall            | 16               | WD FR STUC    | 100          |
| Roof Structur            | 08               | IRREGULAR     | 100          |
| Roof Cover               | 03               | COMP SHNGL    | 100          |
| Interior Wall            | 05               | DRYWALL       | 100          |
| Interior Floo            | 14               | CARPET        | 70           |
| Interior Floo            | 11               | CLAY TILE     | 30           |
| Air Condition            | 03               | CENTRAL       | 100          |
| Heating Type             | 04               | AIR DUCTED    | 100          |
| Bedrooms                 |                  | 3             | 100          |
| Bathrooms                |                  | 2             | 100          |
| Frame                    | 02               | WOOD FRAME    | 100          |
| Stories                  | 1.               | 1.            | 100          |
| Units                    |                  | 0             | 100          |
| Occupancy                | 00               | NONE          | 100          |
| Quality                  | 02               | Quality Level | 02           |
| DOR CODE                 | 0100             | SINGLE FAMILY |              |
| MAP NUM                  |                  | MKT AREA      | 04           |
| NEIGHBORHOOD/LOC         | 4043.00          |               |              |
| AREA TYPE                | TOTAL GROSS AREA | PCT OF BASE   | TOT ADJ AREA |
| BAS                      | 2,142            | 100           | 2,142        |
| FGR                      | 400              | 55            | 220          |
| FOP                      | 51               | 30            | 15           |
| FOP                      | 176              | 30            | 53           |
| TOTALS                   | 2,769            |               | 2,430        |

| MARKET ADJUSTMENTS                                         |     |           |             |                |                |      |      |      |      |      |        |
|------------------------------------------------------------|-----|-----------|-------------|----------------|----------------|------|------|------|------|------|--------|
| TYPE                                                       | MDL | EFF. AREA | TOT ADJ PTS | EFF. BASE RATE | REPL. COST NEW | AYB  | EYB  | ECON | FNCT | NORM | % COND |
| 0900                                                       | 01  | 2,430     | 105.1099    | 124.82         | 303,313        | 2005 | 2005 | 0    | 0    | 8.50 | 91.50  |
| 1 SNGL FAM - 100% - 2023 Heated Area: 2142 HX Base Yr 2023 |     |           |             |                |                |      |      |      |      |      |        |

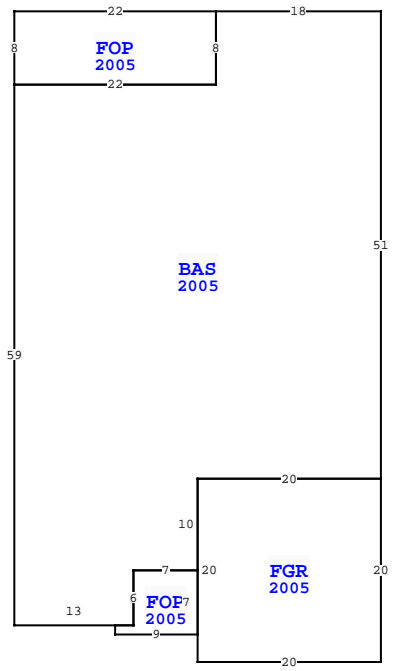

| NASSAU COUNTY PROPERTY    |              | PAGE 1 of 1 |
|---------------------------|--------------|-------------|
| VALUATION SUMMARY         |              |             |
| VALUATION BY              | Tax Group: 4 | STANDARD    |
| BUILDING MARKET VALUE     | Tax Dist:    |             |
| TOTAL MARKET OB/XF VALUE  |              | 277,531     |
| TOTAL LAND VALUE - MARKET |              | 45,859      |
| TOTAL MARKET VALUE        |              | 85,000      |
| SOH/AGL Deduction         |              | 0           |
| ASSESSED VALUE            |              | 408,390     |
| TOTAL EXEMPTION VALUE     | HX HB        | 50,000      |
| BASE TAXABLE VALUE        |              | 358,390     |
| TOTAL JUST VALUE          |              | 408,390     |
| NCON VALUE                |              | 0           |
| INCOME VALUE              |              |             |
| PREVIOUS YEAR MKT VALUE   |              | 349,718     |

| PERMIT NUM | DESCRIPTION | AMT     | ISSUED     |
|------------|-------------|---------|------------|
| B17114     | SWIM POOL   | 35,600  | 02/01/2006 |
| E15710     | ELEC OTHER  | 2,000   | 09/01/2005 |
| M10346     | MECH OTHER  | 0       | 09/01/2005 |
| P059839    | NEW CONSTR  | 0       | 08/01/2005 |
| R0507810   | REPAIR/RRF  | 5,000   | 06/01/2005 |
| B0515481   | NEW CONSTR  | 180,000 | 06/01/2005 |

| SALES DATA                     |           |           |       |       |        |            |
|--------------------------------|-----------|-----------|-------|-------|--------|------------|
| OFF RECORD Number              | DATE      | TYPE INST | Q / U | V / I | RSN CD | SALE PRICE |
| 2567/1051                      | 6/03/2022 | WD Q      | Q     | I     | 01     | 486,000    |
| GRANTOR: CLEVES ALAN A & ANGEL |           |           |       |       |        |            |
| GRANTEE: TANTON GENE D & EMI   |           |           |       |       |        |            |
| 2112/1966                      | 4/10/2017 | WD U      | U     | I     | 19     | 245,000    |
| GRANTOR: MAURO KIMBERLY P/R    |           |           |       |       |        |            |
| GRANTEE: CLEVES ALAN A & ANG   |           |           |       |       |        |            |

| EXTRA FEATURES |            |             |         |     |    |       |    |          |                |           |         |             |   |        |                 |       |
|----------------|------------|-------------|---------|-----|----|-------|----|----------|----------------|-----------|---------|-------------|---|--------|-----------------|-------|
| L N            | OB/XF CODE | DESCRIPTION | BLD CAP | L   | W  | UNITS | UT | Adj R    | ADJ UNIT PRICE | ORIG COND | YEAR ON | YEAR ACTUAL | Q | % COND | OB/XF MKT VALUE | NOTES |
| 1              | 0845       | KOOL DECK   | 0       | 100 | 0  | 0     |    | 730.00   | SF 14.50       | 100       | 2006    | 2006        | 3 | 88     | 9,315           |       |
| 2              | 0871       | POOL HTR R  | 0       | 100 | 0  | 0     |    | 1.00     | UT 4,000.00    | 100       | 2006    | 2006        | 3 | 31     | 1,240           |       |
| 3              | 0877       | JACUZZI     | 0       | 100 | 0  | 0     |    | 1.00     | UT 1,000.00    | 100       | 2006    | 2006        | 3 | 31     | 310             |       |
| 4              | 0911       | SCRN RM A   | 0       | 100 | 40 | 31    |    | 1,240.00 | SF 17.50       | 100       | 2006    | 2006        | 3 | 31     | 6,727           |       |
| 5              | 0500       | FP-PRE FAB  | 0       | 100 | 0  | 0     |    | 1.00     | UT 3,500.00    | 100       | 2005    | 2005        | 3 | 90     | 3,150           |       |
| 6              | 0810       | CONCRETE A  | 0       | 100 | 41 | 18    |    | 738.00   | SF 6.50        | 100       | 2005    | 2005        | 3 | 87     | 4,173           |       |
| 7              | 0810       | CONCRETE A  | 0       | 100 | 12 | 2     |    | 24.00    | SF 6.50        | 100       | 2005    | 2005        | 3 | 87     | 136             |       |
| 8              | 0861       | POOL GUNIT  | 0       | 100 | 0  | 0     |    | 510.00   | SF 85.00       | 100       | 2006    | 2006        | 3 | 48     | 20,808          |       |
| TOTALS         |            |             |         |     |    |       |    |          |                |           |         |             |   |        | 45,859          |       |

| LAND DESCRIPTION |          |     |                      |     |     |          |       |       |             |           |     |          |        |         | TOTAL OB/XF |                |            |                             |      |         |      |     |    |        |
|------------------|----------|-----|----------------------|-----|-----|----------|-------|-------|-------------|-----------|-----|----------|--------|---------|-------------|----------------|------------|-----------------------------|------|---------|------|-----|----|--------|
| L N              | USE CODE | CLS | LAND USE DESCRIPTION | CAP | R D | LOC ZONE | FRONT | DEPTH | TOT LND UTS | UNIT TYPE | D T | DPH FACT | % COND | TOT ADJ | UNIT PRICE  | ADJ UNIT PRICE | LAND VALUE | OTHER ADJUSTMENTS AND NOTES | YEAR | DENSITY | DECL | FRZ | YR | CONSRV |
| 1                | 000136   | C   | SFR INT              | 100 |     |          | 0.00  | 0.00  | 1.00        | LT        |     | 1.00     | 1.00   | 1.00    | 85,000.00   | 85,000.00      | 85,000     |                             |      |         |      |     |    |        |