

| BUILDING CHARACTERISTICS |                  | CONSTRUCTION     |              |
|--------------------------|------------------|------------------|--------------|
| ELEMENT                  | CD               |                  |              |
| Exterior Wall            | 16               | WD FR STUC       | 100          |
| Roof Structur            | 08               | IRREGULAR        | 100          |
| Roof Cover               | 03               | COMP SHNGL       | 100          |
| Interior Wall            | 05               | DRYWALL          | 100          |
| Interior Floo            | 11               | CLAY TILE        | 60           |
| Interior Floo            | 14               | CARPET           | 40           |
| Air Condition            | 03               | CENTRAL          | 100          |
| Heating Type             | 04               | AIR DUCTED       | 100          |
| Bedrooms                 |                  | 3                | 100          |
| Bathrooms                |                  | 3                | 100          |
| Frame                    | 02               | WOOD FRAME       | 100          |
| Stories                  | 1.               | 1.               | 100          |
| Units                    |                  | 0                | 100          |
| Occupancy                | 00               | NONE             | 100          |
| Quality                  | 04               | Quality Level 04 |              |
| DOR CODE                 | 0100             | SINGLE FAMILY    |              |
| MAP NUM                  |                  | MKT AREA         | 04           |
| NEIGHBORHOOD/LOC         | 4043.00          |                  |              |
| AREA TYPE                | TOTAL GROSS AREA | PCT OF BASE      | TOT ADJ AREA |
| BAS                      | 2,326            | 100              | 2,326        |
| FGR                      | 798              | 55               | 439          |
| FOP                      | 66               | 30               | 20           |
| FOP                      | 225              | 30               | 68           |
| TOTALS                   | 3,415            |                  | 2,853        |

| MARKET ADJUSTMENTS   |     |           |             |                |                |      |      |      |      |      |        |
|--|-----|-----------|-------------|----------------|----------------|------|------|------|------|------|--------|
| TYPE   | MDL | EFF. AREA | TOT ADJ PTS | EFF. BASE RATE | REPL. COST NEW | AYB  | EYB  | ECON | FNCT | NORM | % COND |
| 0900   | 01  | 2,853     | 118.2426    | 140.41         | 400,590        | 2006 | 2011 | 0    | 0    | 5.50 | 94.50  |
| 1 SNGL FAM - 100% - 2009 Heated Area: 2326 HX Base Yr 2009 |     |           |             |                |                |      |      |      |      |      |        |

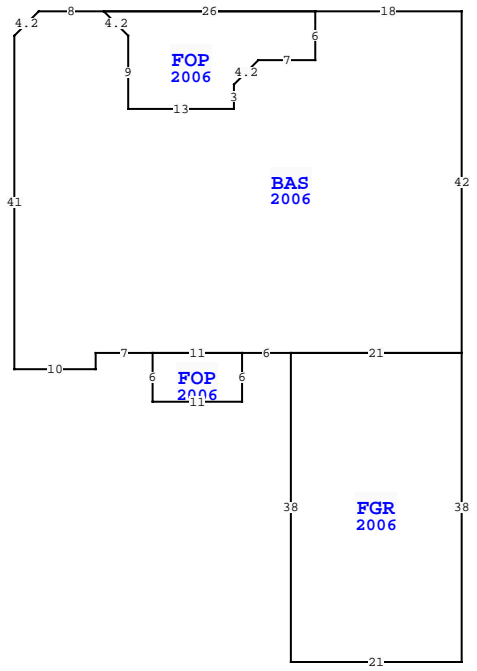

| NASSAU COUNTY PROPERTY  |             |           |            | PAGE 1 of 1 | 4          |
|---|-------------|-----------|------------|-------------|------------|
| VALUATION SUMMARY   |             |           |            |             |            |
| VALUATION BY  |             |           |            | STANDARD    |            |
| Tax Group: 4  |             |           |            | Tax Dist:   |            |
| BUILDING MARKET VALUE   |             |           |            | 378,558     |            |
| TOTAL MARKET OB/XF VALUE  |             |           |            | 8,937       |            |
| TOTAL LAND VALUE - MARKET   |             |           |            | 127,500     |            |
| TOTAL MARKET VALUE  |             |           |            | 514,995     |            |
| SOH/AGL Deduction   |             |           |            | 220,384     |            |
| ASSESSED VALUE  |             |           |            | 294,611     |            |
| TOTAL EXEMPTION VALUE   |             |           |            | 50,000      |            |
| BASE TAXABLE VALUE  |             |           |            | 244,611     |            |
| TOTAL JUST VALUE  |             |           |            | 514,995     |            |
| NCON VALUE  |             |           |            | 0           |            |
| INCOME VALUE  |             |           |            |             |            |
| PREVIOUS YEAR MKT VALUE   |             |           |            | 401,566     |            |
| PERMIT NUM  | DESCRIPTION | AMT       | ISSUED     |             |            |
| 20007259  | REPAIR/RRF  | 23,540    | 09/02/2020 |             |            |
| E17075  | ELEC OTHER  | 1,500     | 04/01/2006 |             |            |
| P10975  | OTHER       | 0         | 04/01/2006 |             |            |
| C17426  | CO ISSUED   | 457,775   | 03/01/2006 |             |            |
| R09083  | REPAIR/RRF  | 3,500     | 03/01/2006 |             |            |
| B17426  | NEW CONSTR  | 457,775   | 03/01/2006 |             |            |
| SALES DATA  |             |           |            |             |            |
| OFF RECORD Number   | DATE        | TYPE INST | Q / V / I  | RSN CD      | SALE PRICE |
| 1551/0667   | 2/15/2008   | WD Q      | Q I        |             | 373,100    |
| GRANTOR: INTERVEST CONSTRUCTIO  |             |           |            |             |            |
| GRANTEE: MILLER GARY R & ALI  |             |           |            |             |            |
| 1066/1814   | 7/05/2002   | WD U      | V 19       |             | 750,000    |
| GRANTOR: NORTH HAMPTON LLC  |             |           |            |             |            |
| GRANTEE: INTERVEST CONSTRUCT  |             |           |            |             |            |
| BUILDING NOTES  |             |           |            |             |            |
| BUILDING DIMENSIONS   |             |           |            |             |            |
| BAS=[YR=2006] W18 FOP=[YR=2006] S6 W7 D3 L3 S3 W13 N9 U3 L3 E26 \$ W26 W8 D3 L3 S41 E10 N2 E7 FOP=[YR=2006] S6 E11 N6 W11 \$ E11 E6 FGR=[YR=2006] S38 E21 N38 W21 \$ E21 N42 \$ . |             |           |            |             |            |

| EXTRA FEATURES |            |             |         |     |   |          |    |          |                |           |         |             |   |        |                 |       |
|----------------|------------|-------------|---------|-----|---|----------|----|----------|----------------|-----------|---------|-------------|---|--------|-----------------|-------|
| L N            | OB/XF CODE | DESCRIPTION | BLD CAP | L   | W | UNITS    | UT | Adj R    | ADJ UNIT PRICE | ORIG COND | YEAR ON | YEAR ACTUAL | Q | % COND | OB/XF MKT VALUE | NOTES |
| 1              | 0500       | FP-PRE FAB  | 0       | 100 | 0 | 1.00     | UT | 3,500.00 | 3,500.00       | 100       | 2006    | 2006        | 3 | 91     | 3,185           |       |
| 2              | 0812       | CONCRETE C  | 0       | 100 | 0 | 1,634.00 | SF | 4.00     | 4.00           | 100       | 2006    | 2006        | 3 | 88     | 5,752           |       |
| TOTALS         |            |             |         |     |   |          |    |          |                |           |         | 8,937       |   |        |                 |       |

| LAND DESCRIPTION |          |     |                      |     |     |          |       |       |             |           |     | TOTAL OB/XF |        |         |            |                |            |                             |      |         |      |     |    |        |
|------------------|----------|-----|----------------------|-----|-----|----------|-------|-------|-------------|-----------|-----|-------------|--------|---------|------------|----------------|------------|-----------------------------|------|---------|------|-----|----|--------|
| L N              | USE CODE | CLS | LAND USE DESCRIPTION | CAP | R D | LOC ZONE | FRONT | DEPTH | TOT LND UTS | UNIT TYPE | D T | DPH FACT    | % COND | TOT ADJ | UNIT PRICE | ADJ UNIT PRICE | LAND VALUE | OTHER ADJUSTMENTS AND NOTES | YEAR | DENSITY | DECL | FRZ | YR | CONSRV |
| 1                | 000135   | C   | SFR CNSVTN           | 100 |     | PUD      | 0.00  | 0.00  | 1.00        | LT        |     | 1.00        | 1.00   | 1.00    | 127,500.00 | 127,500.00     | 127,500    |                             |      |         |      |     |    |        |