

BUILDING CHARACTERISTICS		CONSTRUCTION		
ELEMENT	CD			
Exterior Wall	25	MOD METAL 60		
Exterior Wall	15	CONC BLOCK 40		
Roof Structure	10	STEEL FRME 100		
Roof Cover	12	MODULAR MT 60		
Roof Cover	04	BUILT-UP 40		
Interior Wall	01	MINIMUM 100		
Interior Floor	03	CONC FINSH 100		
Ceiling	04	NONE 100		
Air Condition	01	NONE 100		
Heating Type	01	NONE 100		
Plumbing		3 100		
Frame	05	STEEL 100		
Story Height		14 100		
RMS		4 100		
Stories	1.	1. 100		
Class	00	. 100		
Units		0 100		
BUD8 Adjustme	02	DIST FB 100		
Quality	00	Quality Control	03	
DOR CODE	4100	LIGHT MANUFACTURE		
MAP NUM		MKT AREA	01	
NEIGHBORHOOD/LOC		1010.00		
AREA TYPE	TOTAL GROSS AREA	PCT OF BASE	TOT ADJ AREA	SUBAREA MARKET VALUE
BAS	5,688	100	5,688	175,764
CAN	285	30	86	2,657
TOTALS	5,973		5,774	178,421

MARKET ADJUSTMENTS											
TYPE	MDL	EFF. AREA	TOT ADJ PTS	EFF. BASE RATE	REPL. COST NEW	AYB	EYB	ECON	FNCT	NORM	% COND
1	LGHT MANUF	- 0%	- 2017								
Heated Area: 5688						HX Base Yr 2017					

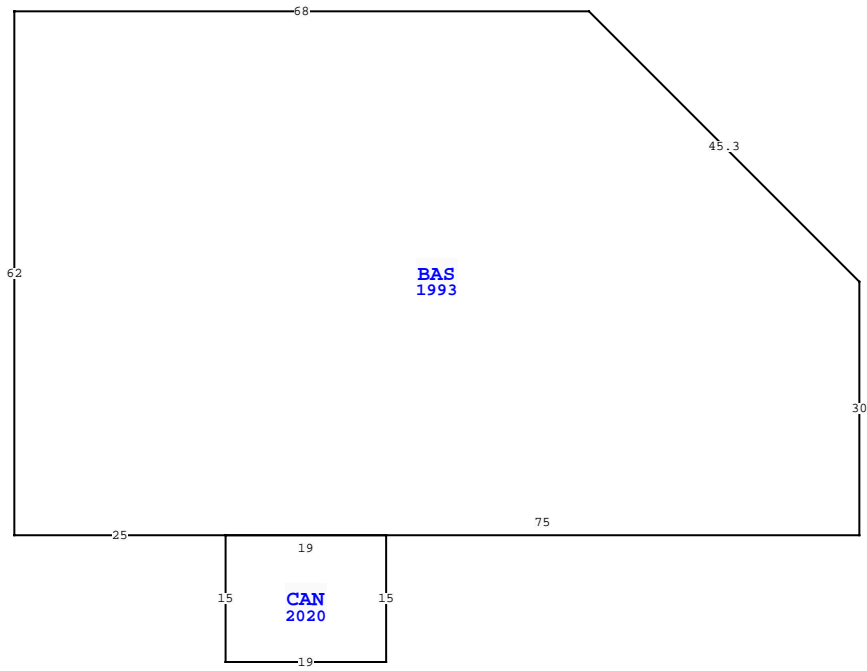

NASSAU COUNTY PROPERTY		PAGE 1 of 2
VALUATION SUMMARY		
VALUATION BY		STANDARD
Tax Group: 2	Tax Dist:	
BUILDING MARKET VALUE		257,721
TOTAL MARKET OB/XF VALUE		18,211
TOTAL LAND VALUE - MARKET		294,030
TOTAL MARKET VALUE		569,962
SOH/AGL Deduction		235,564
ASSESSED VALUE		334,398
TOTAL EXEMPTION VALUE	HX HB	36,544
BASE TAXABLE VALUE		297,854
TOTAL JUST VALUE		569,962
NCON VALUE		0
INCOME VALUE		
PREVIOUS YEAR MKT VALUE		494,249

PERMIT NUM	DESCRIPTION	AMT	ISSUED

SALES DATA						
OFF RECORD Number	DATE	TYPE INST	Q U	V I	RSN CD	SALE PRICE
1555/1813	3/14/2008	QC	U	I	01	100
GRANTOR: GIEDRYS HONORATA KRYS						
GRANTEE: GIEDRYS NORA						
0974/1225	3/09/2001	QC	U	I	01	100
GRANTOR: GIEDRYS ALEX TRUSTEES						
GRANTEE: GIEDRYS HONORATA KR						

EXTRA FEATURES															TOTAL OB/XF										
L N	OB/XF CODE	DESCRIPTION	BLD CAP	L	W	UNITS	UT	Adj R	ADJ UNIT PRICE	ORIG COND	YEAR ON	YEAR ACTUAL	Q	% COND	OB/XF MKT VALUE	NOTES									
2	0424	CL FNC 6'	0	100	0	89.00	LF	20.00	20.00	100	1987	1987	3	25	445										
3	0812	CONCRETE C	0	100	65	1,950.00	SF	4.00	4.00	100	1995	1995	3	72	5,616										
5	0940	SHEDS/PORT	0	100	12	144.00	SF	42.60	42.60	100	2002	2002	3	21	1,288										
7	1242	WD DECK A	0	100	0	160.00	SF	14.20	14.20	100	1994	1994	3	20	454										
8	0350	CARPORT WD	0	100	0	160.00	SF	8.58	8.58	100	2008	2008	3	40	549										
9	0940	SHEDS/PORT	0	100	12	144.00	SF	30.00	30.00	100	2008	2008	3	40	1,728										
10	0940	SHEDS/PORT	0	100	14	168.00	SF	30.00	30.00	100	2008	2008	3	40	2,016										
11	0510	GARAGE WD-	0	100	26	312.00	SF	35.00	35.00	100	2008	2008	3	56	6,115										
TOTALS															18,211										

BUILDING NOTES									

BUILDING DIMENSIONS									
BAS=[YR=1993] U32 L32 W68 S62 E25 CAN=[YR=2020] S15 E19 N15 W19\$ E75 N30\$.									

LAND DESCRIPTION										TOTAL OB/XF														
L N	USE CODE	CLS	LAND USE DESCRIPTION	CAP	R D	LOC ZONE	FRONT	DEPTH	TOT LND UTS	UNIT TYPE	D T	DPH FACT	% COND	TOT ADJ	UNIT PRICE	ADJ UNIT PRICE	LAND VALUE	OTHER ADJUSTMENTS AND NOTES	YEAR	DENSITY	DECL	FRZ	YR	CONSRV
1	004100	C	LIGHT MFG.	0	0006	MU-1	100.00	125.00	13,068.00	SF		1.00	1.00	0.50	45.00	22.50	294,030							

