

BUILDING CHARACTERISTICS		CONSTRUCTION		
ELEMENT	CD			
Exterior Wall	05	AVERAGE	100	
Roof Structur	03	GABLE/HIP	100	
Roof Cover	03	COMP SHNGL	100	
Interior Wall	05	DRYWALL	80	
Interior Wall	06	CUST PANEL	20	
Interior Floo	14	CARPET	80	
Interior Floo	08	SHT VINYL	20	
Air Condition	03	CENTRAL	100	
Heating Type	04	AIR DUCTED	100	
Bedrooms		3	100	
Bathrooms		1	100	
Frame	02	WOOD FRAME	100	
Stories	1.	1.	100	
Units		0	100	
Occupancy	00	NONE	100	
Quality	03	Quality Level	03	
DOR CODE	0100	SINGLE FAMILY		
MAP NUM		MKT AREA	01	
NEIGHBORHOOD/LOC		1009.00		
AREA TYPE	TOTAL GROSS AREA	PCT OF BASE	TOT ADJ AREA	SUBAREA MARKET VALUE
BAS	1,750	100	1,750	137,224
FOP	196	30	59	4,626
FOP	196	30	59	4,626
TOTALS	2,142		1,868	146,477

MARKET ADJUSTMENTS												
TYPE	MDL	EFF. AREA	TOT ADJ PTS	EFF. BASE RATE	REPL. COST NEW	AYB	EYB	ECON	FNCT	NORM	% COND	
1	SINGLE FAM	- 100%	- 1996		168,849	1995	1995	0	0	0	13.25	86.75
Heated Area: 1750						HX Base Yr 1996						

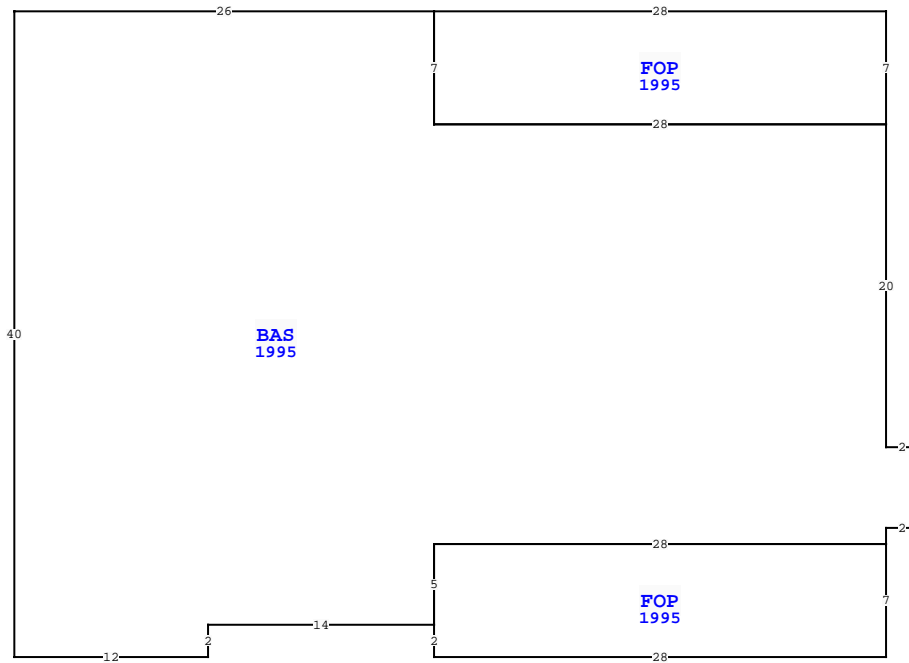

NASSAU COUNTY PROPERTY			
VALUATION SUMMARY			PAGE 1 of 2
VALUATION BY			STANDARD
Tax Group: 2	Tax Dist:		
BUILDING MARKET VALUE			152,450
TOTAL MARKET OB/XF VALUE			1,912
TOTAL LAND VALUE - MARKET			302,720
TOTAL MARKET VALUE			457,082
SOH/AGL Deduction			202,951
ASSESSED VALUE			254,131
TOTAL EXEMPTION VALUE	HX HB		50,000
BASE TAXABLE VALUE			204,131
TOTAL JUST VALUE			457,082
NCON VALUE			0
INCOME VALUE			
PREVIOUS YEAR MKT VALUE			457,413

PERMIT NUM	DESCRIPTION	AMT	ISSUED
20080348	REPAIR/RRF	1,800	03/06/2008

SALES DATA						
OFF RECORD Number	DATE	TYPE INST	Q / U	V / I	RSN CD	SALE PRICE
2365/0319	5/27/2020	QC	U	I	11	100
GRANTOR: KEMP JEANETTE M						
GRANTEE: KEMP ROY GREEN & JE						
0561/0912	1/23/1989	WD	U	V	01	100
GRANTOR: MURPHY SADIE M						
GRANTEE: KEMP ROY GREEN						

EXTRA FEATURES																	
L N	OB/XF CODE	DESCRIPTION	BLD CAP	L	W	UNITS	UT	Adj R	ADJ UNIT PRICE	ORIG COND	YEAR ON	YEAR ACTUAL	Q	% COND	OB/XF MKT VALUE	NOTES	
1	0810	CONCRETE A	0	100	6	2			12.00	SF	6.50	100	1995	1995	3	72	56
2	1243	WD DECK F	0	100	6	6			36.00	SF	8.00	100	1995	1995	3	20	58
3	0940	SHEDS/PORT	0	100	10	13			130.00	SF	30.00	100	1998	1998	3	20	780
4	0810	CONCRETE A	0	100	4	12			48.00	SF	6.50	100	1966	1966	3	20	62
5	0810	CONCRETE A	0	100	5	27			135.00	SF	6.50	100	1966	1966	3	20	176
6	0940	SHEDS/PORT	0	100	10	13			130.00	SF	30.00	100	1990	1990	3	20	780
TOTALS															1,912		

LAND DESCRIPTION																							
L N	USE CODE	CLS	LAND USE DESCRIPTION	CAP	R D	LOC ZONE	FRONT	DEPTH	TOT LND UTS	UNIT TYPE	D T	% COND	TOT ADJ	UNIT PRICE	ADJ UNIT PRICE	LAND VALUE	OTHER ADJUSTMENTS AND NOTES	YEAR	DENSITY	DECL	FRZ	YR	CONSRV
1	000100	C	SFR	100		CPO	86.00	230.00	172.00	FF		1.00	1.00	0.88	2,000.00	1,760.00	302,720						

