

| BUILDING CHARACTERISTICS |                  | CONSTRUCTION       |              |
|--------------------------|------------------|--------------------|--------------|
| ELEMENT                  | CD               |                    |              |
| Exterior Wall            | 15               | CONC BLOCK         | 100          |
| Roof Structur            | 04               | WOOD TRUSS         | 100          |
| Roof Cover               | 03               | COMP SHNGL         | 100          |
| Interior Wall            | 06               | CUST PANEL         | 100          |
| Interior Floor           | 12               | HARDWOOD           | 70           |
| Interior Floor           | 14               | CARPET             | 30           |
| Ceiling                  | 01               | FIN.SUSPD          | 100          |
| Air Condition            | 03               | CENTRAL            | 100          |
| Heating Type             | 04               | AIR DUCTED         | 100          |
| Fixtures                 |                  | 9                  | 100          |
| Frame                    | 03               | MASONRY            | 100          |
| Story Height             |                  | 7                  | 100          |
| RMS                      |                  | 6                  | 100          |
| Stories                  | 1.               | 1.                 | 100          |
| Units                    |                  | 0                  | 100          |
| Occupancy                | 00               | OWNER OCC          | 100          |
| Quality                  | 03               | Quality Level 03   |              |
| DOR CODE                 | 1200             | STORE/OFFICE/RESID |              |
| MAP NUM                  |                  | MKT AREA           | 01           |
| NEIGHBORHOOD/LOC         | 2004.00          |                    |              |
| AREA TYPE                | TOTAL GROSS AREA | PCT OF BASE        | TOT ADJ AREA |
| BAS                      | 1,782            | 100                | 1,782        |
| FCP                      | 210              | 30                 | 63           |
| FOP                      | 78               | 30                 | 23           |
| FST                      | 130              | 50                 | 65           |
| STP                      | 19               | 10                 | 2            |
| TOTALS                   | 2,219            |                    | 1,935        |
|                          |                  |                    | 147,811      |

| MARKET ADJUSTMENTS                                 |     |           |             |                |                |      |      |      |      |      |        |       |
|--|-----|-----------|-------------|----------------|----------------|------|------|------|------|------|--------|-------|
| TYPE   | MDL | EFF. AREA | TOT ADJ PTS | EFF. BASE RATE | REPL. COST NEW | AYB  | EYB  | ECON | FNCT | NORM | % COND |       |
| 1701   | 04  | 1,935     | 108.6750    | 154.32         | 298,609        | 1953 | 1985 | 0    | 0    | 0    | 50.50  | 49.50 |
| 1 OFFICE 1&2 - 0% - 0 Heated Area: 1782 HX Base Yr |     |           |             |                |                |      |      |      |      |      |        |       |

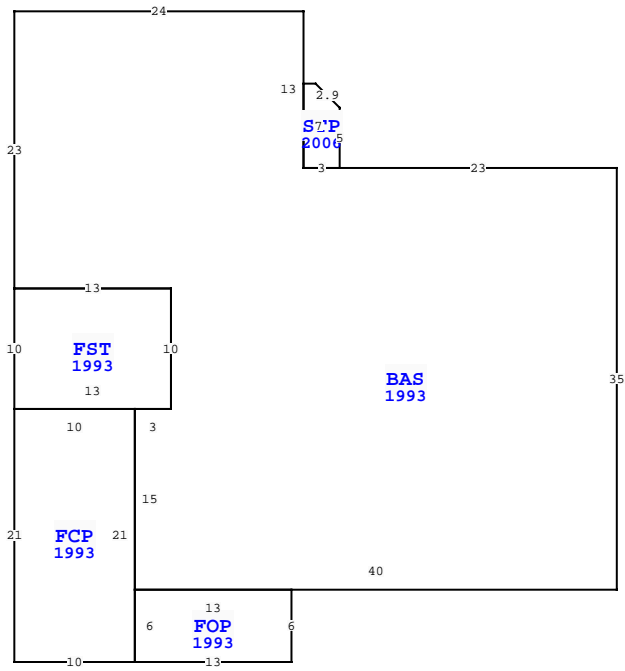

| NASSAU COUNTY PROPERTY    |           | PAGE 1 of 3 | 2        |
|---------------------------|-----------|-------------|----------|
| VALUATION SUMMARY         |           |             |          |
| VALUATION BY              |           |             | STANDARD |
| Tax Group: 2              | Tax Dist: |             |          |
| BUILDING MARKET VALUE     |           |             | 345,326  |
| TOTAL MARKET OB/XF VALUE  |           |             | 71,796   |
| TOTAL LAND VALUE - MARKET |           |             | 495,500  |
| TOTAL MARKET VALUE        |           |             | 912,622  |
| SOH/AGL Deduction         |           |             | 217,256  |
| ASSESSED VALUE            |           |             | 695,366  |
| TOTAL EXEMPTION VALUE     |           |             | 0        |
| BASE TAXABLE VALUE        |           |             | 695,366  |
| TOTAL JUST VALUE          |           |             | 912,622  |
| NCON VALUE                |           |             | 0        |
| INCOME VALUE              |           |             |          |
| PREVIOUS YEAR MKT VALUE   |           |             | 680,694  |

| PERMIT NUM | DESCRIPTION       | AMT    | ISSUED     |
|------------|-------------------|--------|------------|
| 20200046   | ROOF - 1666 S 8TH | 12,000 | 11/09/2020 |
| 20170691   | XFOB              | 2,975  | 03/09/2017 |
| 20071035   | REMODEL           | 700    | 06/11/2007 |
| 20070952   | H/AC              | 3,500  | 05/31/2007 |
| 20070953   | REMODEL           | 1,000  | 05/31/2007 |
| 20070519   | REMODEL           | 21,450 | 03/28/2007 |

| SALES DATA                     |           |           |       |       |        |            |
|--------------------------------|-----------|-----------|-------|-------|--------|------------|
| OFF RECORD Number              | DATE      | TYPE INST | Q / U | V / I | RSN CD | SALE PRICE |
| 2646/606                       | 6/02/2023 | WD        | U     | I     | 17     | 825,000    |
| GRANTOR: MILLER CLARA VERN TRU |           |           |       |       |        |            |
| GRANTEE: FIRST BAPTIST CHURC   |           |           |       |       |        |            |
| 1609/1704                      | 3/04/2009 | WD        | U     | I     | 30     | 100        |
| GRANTOR: MILLER DAVID F SR     |           |           |       |       |        |            |
| GRANTEE: MILLER CLARA VERN T   |           |           |       |       |        |            |

| EXTRA FEATURES |            |             |     |     |    |    |        |    |       |                |           |         |             |   |        |                 |       |
|----------------|------------|-------------|-----|-----|----|----|--------|----|-------|----------------|-----------|---------|-------------|---|--------|-----------------|-------|
| L N            | OB/XF CODE | DESCRIPTION | BLD | CAP | L  | W  | UNITS  | UT | Adj R | ADJ UNIT PRICE | ORIG COND | YEAR ON | YEAR ACTUAL | Q | % COND | OB/XF MKT VALUE | NOTES |
| 1              | 0810       | CONCRETE A  | 0   | 0   | 0  | 0  | 770.00 | SF | 6.50  | 6.50           | 100       | 1980    | 1980        | 3 | 35     | 1,752           |       |
| 2              | 0810       | CONCRETE A  | 0   | 0   | 0  | 0  | 407.00 | SF | 6.50  | 6.50           | 100       | 1989    | 1989        | 3 | 59.5   | 1,574           |       |
| 3              | 0810       | CONCRETE A  | 0   | 0   | 7  | 4  | 28.00  | SF | 6.50  | 6.50           | 100       | 1989    | 1989        | 3 | 59.5   | 108             |       |
| 4              | 0810       | CONCRETE A  | 0   | 0   | 0  | 0  | 165.00 | SF | 6.50  | 6.50           | 100       | 1955    | 1955        | 3 | 20     | 215             |       |
| 5              | 0810       | CONCRETE A  | 0   | 0   | 0  | 0  | 110.00 | SF | 6.50  | 6.50           | 100       | 1955    | 1955        | 3 | 20     | 143             |       |
| 6              | 0810       | CONCRETE A  | 0   | 0   | 3  | 4  | 12.00  | SF | 6.50  | 6.50           | 100       | 1984    | 1984        | 3 | 47     | 37              |       |
| 7              | 0646       | LWN SPRK H  | 0   | 0   | 0  | 0  | 7.00   | UT | 4.00  | 4.00           | 100       | 2000    | 2000        | 3 | 27     | 8               |       |
| 8              | 0510       | GARAGE WD-  | 0   | 0   | 30 | 15 | 450.00 | SF | 35.00 | 35.00          | 100       | 1999    | 1999        | 3 | 28     | 4,410           |       |
| 9              | 0510       | GARAGE WD-  | 0   | 0   | 20 | 24 | 480.00 | SF | 29.75 | 29.75          | 100       | 2000    | 2000        | 3 | 29     | 4,141           |       |
| 10             | 0510       | GARAGE WD-  | 0   | 0   | 22 | 22 | 484.00 | SF | 19.60 | 19.60          | 100       | 2000    | 2000        | 3 | 29     | 2,751           |       |

| LAND DESCRIPTION |          |     |                      |     |      |          |        |        |             |           |     |          | TOTAL OB/XF |         |            |                |            |                             |      |         |      |     |    |        |
|------------------|----------|-----|----------------------|-----|------|----------|--------|--------|-------------|-----------|-----|----------|-------------|---------|------------|----------------|------------|-----------------------------|------|---------|------|-----|----|--------|
| L N              | USE CODE | CLS | LAND USE DESCRIPTION | CAP | R D  | LOC ZONE | FRONT  | DEPTH  | TOT LND UTS | UNIT TYPE | D T | DPH FACT | % COND      | TOT ADJ | UNIT PRICE | ADJ UNIT PRICE | LAND VALUE | OTHER ADJUSTMENTS AND NOTES | YEAR | DENSITY | DECL | FRZ | YR | CONSRV |
| 1                | 001700   | C   | 1STORY OFF           | 0   | 0003 | C-2      | 174.00 | 228.00 | 39,640.00   | SF        |     | 1.00     | 1.00        | 1.00    | 12.50      | 12.50          | 495,500    |                             |      |         |      |     |    |        |

| REVIEW DATE 01/12/2021 BY KK |  |  |  |  |                           |  |  |  |  |           |  |  |  |  |                 |  |  |  |  |                 |  |  |  |  |
|------------------------------|--|--|--|--|---------------------------|--|--|--|--|-----------|--|--|--|--|-----------------|--|--|--|--|-----------------|--|--|--|--|
| Total Acres: 0.00            |  |  |  |  | Total Land Value: 495,500 |  |  |  |  | Market: 0 |  |  |  |  | Agricultural: 0 |  |  |  |  | Common: 495,500 |  |  |  |  |

| BUILDING CHARACTERISTICS |                  | CONSTRUCTION       |              |
|--------------------------|------------------|--------------------|--------------|
| ELEMENT                  | CD               |                    |              |
| Exterior Wall            | 15               | CONC BLOCK         | 100          |
| Roof Structur            | 04               | WOOD TRUSS         | 100          |
| Roof Cover               | 03               | COMP SHNGL         | 100          |
| Interior Wall            | 05               | DRYWALL            | 60           |
| Interior Wall            | 01               | MINIMUM            | 40           |
| Interior Floo            | 14               | CARPET             | 100          |
| Ceiling                  | 01               | FIN.SUSPD          | 100          |
| Air Condition            | 03               | CENTRAL            | 100          |
| Heating Type             | 04               | AIR DUCTED         | 100          |
| Fixtures                 |                  | 10 100             |              |
| Frame                    | 03               | MASONRY            | 100          |
| Story Height             |                  | 7 100              |              |
| RMS                      |                  | 7 100              |              |
| Stories                  | 1.               | 1. 100             |              |
| Units                    |                  | 0 100              |              |
| Occupancy                | OP               | OWNER/PART         | 100          |
| Quality                  | 03               | Quality Level      | 03           |
| DOR CODE                 | 1200             | STORE/OFFICE/RESID |              |
| MAP NUM                  |                  | MKT AREA           | 01           |
| NEIGHBORHOOD/LOC         | 2004.00          |                    |              |
| AREA TYPE                | TOTAL GROSS AREA | PCT OF BASE        | TOT ADJ AREA |
| BAS                      | 1,953            | 100                | 1,953        |
| BAS                      | 416              | 100                | 416          |
| FOP                      | 78               | 30                 | 23           |
| FOP                      | 84               | 30                 | 25           |
| TOTALS                   | 2,531            |                    | 2,417        |
|                          |                  |                    | 186,423      |

| MARKET ADJUSTMENTS                                 |     |           |             |                |                |      |      |      |      |       |        |
|--|-----|-----------|-------------|----------------|----------------|------|------|------|------|-------|--------|
| TYPE   | MDL | EFF. AREA | TOT ADJ PTS | EFF. BASE RATE | REPL. COST NEW | AYB  | EYB  | ECON | FNCT | NORM  | % COND |
| 1701   | 04  | 2,417     | 91.2870     | 129.63         | 313,316        | 1955 | 1989 | 0    | 0    | 40.50 | 59.50  |
| 2 OFFICE 1&2 - 0% - 0 Heated Area: 2369 HX Base Yr |     |           |             |                |                |      |      |      |      |       |        |

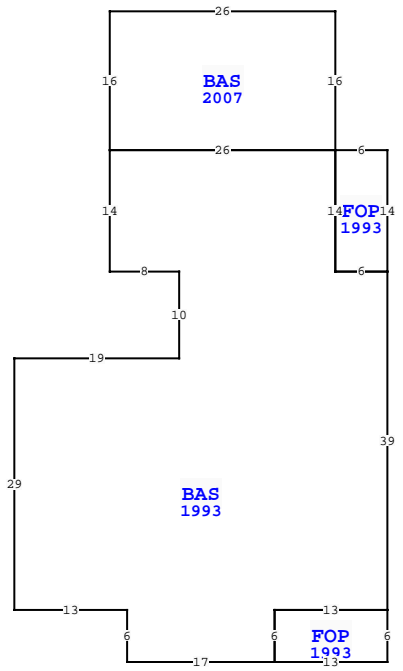

| NASSAU COUNTY PROPERTY    |           | PAGE 2 of 3 |
|---------------------------|-----------|-------------|
| VALUATION SUMMARY         |           |             |
| VALUATION BY              |           | STANDARD    |
| Tax Group: 2              | Tax Dist: |             |
| BUILDING MARKET VALUE     |           | 345,326     |
| TOTAL MARKET OB/XF VALUE  |           | 71,796      |
| TOTAL LAND VALUE - MARKET |           | 495,500     |
| TOTAL MARKET VALUE        |           | 912,622     |
| SOH/AGL Deduction         |           | 217,256     |
| ASSESSED VALUE            |           | 695,366     |
| TOTAL EXEMPTION VALUE     |           | 0           |
| BASE TAXABLE VALUE        |           | 695,366     |
| TOTAL JUST VALUE          |           | 912,622     |
| NCON VALUE                |           | 0           |
| INCOME VALUE              |           |             |
| PREVIOUS YEAR MKT VALUE   |           | 680,694     |

| PERMIT NUM | DESCRIPTION | AMT    | ISSUED     |
|------------|-------------|--------|------------|
| 20061111   | REMODEL     | 650    | 05/19/2006 |
| 20060796   | XFOB        | 42,000 | 04/19/2006 |
| 20060780   | SWIM POOL   | 52,000 | 04/14/2006 |
| 20060645   | DEMOLITION  | 0      | 03/30/2006 |
| 19983417   | REPAIR/RRF  | 2,400  | 03/26/1998 |
| R960488    | REPAIR/RRF  | 2,600  | 01/01/1995 |

| SALES DATA        |           |           |       |       |        |            |
|-------------------|-----------|-----------|-------|-------|--------|------------|
| OFF RECORD Number | DATE      | TYPE INST | Q / U | V / I | RSN CD | SALE PRICE |
| 2646/606          | 6/02/2023 | WD        | U     | I     | 17     | 825,000    |

| BUILDING NOTES                 |           |    |   |   |    |     |
|--------------------------------|-----------|----|---|---|----|-----|
| GRANTOR: MILLER CLARA VERN TRU |           |    |   |   |    |     |
| GRANTEE: FIRST BAPTIST CHURC   |           |    |   |   |    |     |
| 1609/1704                      | 3/04/2009 | WD | U | I | 30 | 100 |
| GRANTOR: MILLER DAVID F SR     |           |    |   |   |    |     |
| GRANTEE: MILLER CLARA VERN T   |           |    |   |   |    |     |

| BUILDING DIMENSIONS   |  |  |  |  |  |  |
|---|--|--|--|--|--|--|
| BAS=[YR=2007] W26 S16 BAS=[YR=1993] S14 E8 S10 W19 S29 E13 S6 E17 FOP=[YR=1993] E13 N6 W13 S6 \$ N6 E13 N39 FOP=[YR=1993] N14 W6 S14 E6 \$ W6 N14 W26 \$ E26 N16 \$ . |  |  |  |  |  |  |

| EXTRA FEATURES |            |             |         |   |    |       |    |          |                |           |         |             |   |        |                 |       |
|----------------|------------|-------------|---------|---|----|-------|----|----------|----------------|-----------|---------|-------------|---|--------|-----------------|-------|
| L N            | OB/XF CODE | DESCRIPTION | BLD CAP | L | W  | UNITS | UT | Adj R    | ADJ UNIT PRICE | ORIG COND | YEAR ON | YEAR ACTUAL | Q | % COND | OB/XF MKT VALUE | NOTES |
| 11             | 0861       | POOL GUNIT  | 0       | 0 | 40 | 11    | SF | 85.00    | 85.00          | 100       | 2006    | 2006        | 3 | 48     | 17,952          |       |
| 12             | 0872       | POOL HTR C  | 0       | 0 | 0  | 0     | UT | 6,000.00 | 6,000.00       | 100       | 2006    | 2006        | 3 | 31     | 1,860           |       |
| 13             | 0855       | CONC PAVER  | 0       | 0 | 0  | 0     | SF | 7.00     | 7.00           | 100       | 2006    | 2006        | 3 | 88     | 18,505          |       |
| 14             | 0911       | SCRN RM A   | 0       | 0 | 0  | 0     | SF | 35.00    | 35.00          | 100       | 2006    | 2006        | 3 | 31     | 11,393          |       |
| 15             | 0888       | AUTO PL CV  | 0       | 0 | 40 | 11    | SF | 7.50     | 7.50           | 100       | 2006    | 2006        | 3 | 48     | 1,584           |       |
| 16             | 0462       | ST/AL FNC   | 0       | 0 | 48 | 0     | SF | 10.00    | 10.00          | 100       | 2006    | 2006        | 3 | 48     | 1,152           |       |
| 17             | 1242       | WD DECK A   | 0       | 0 | 6  | 6     | SF | 10.00    | 10.00          | 100       | 2006    | 2006        | 3 | 31     | 112             |       |
| 19             | 0351       | CARPORT MT  | 0       | 0 | 20 | 20    | SF | 5.90     | 5.90           | 100       | 2005    | 2005        | 3 | 27     | 637             |       |
| 20             | 0463       | FENCE GATE  | 0       | 0 | 0  | 0     | UT | 150.00   | 150.00         | 100       | 2010    | 2010        | 3 | 81     | 243             |       |
| 21             | 0810       | CONCRETE A  | 0       | 0 | 20 | 20    | SF | 6.50     | 6.50           | 100       | 2017    | 2017        | 3 | 97     | 2,522           |       |

| LAND DESCRIPTION |          |     |                      |     |     |          |       |       |             |           |     |          |        |         | TOTAL OB/XF |                |            |                             |      |         |      |     |    |        |
|------------------|----------|-----|----------------------|-----|-----|----------|-------|-------|-------------|-----------|-----|----------|--------|---------|-------------|----------------|------------|-----------------------------|------|---------|------|-----|----|--------|
| L N              | USE CODE | CLS | LAND USE DESCRIPTION | CAP | R D | LOC ZONE | FRONT | DEPTH | TOT LND UTS | UNIT TYPE | D T | DPH FACT | % COND | TOT ADJ | UNIT PRICE  | ADJ UNIT PRICE | LAND VALUE | OTHER ADJUSTMENTS AND NOTES | YEAR | DENSITY | DECL | FRZ | YR | CONSRV |
|                  |          |     |                      |     |     |          |       |       |             |           |     |          |        |         | 55,960      |                |            |                             |      |         |      |     |    |        |

